

# EF Series

平行轴斜齿轮减速机  
Parallel Shaft Helical Gear Motor



**EVERGEAR**

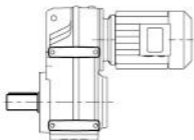
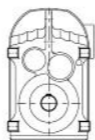
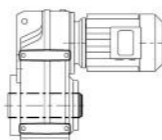
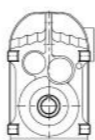
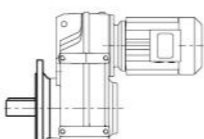
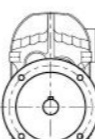
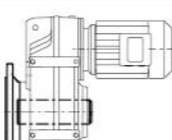
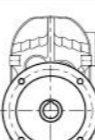
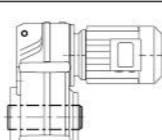
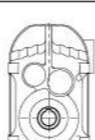
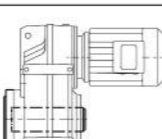
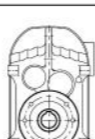
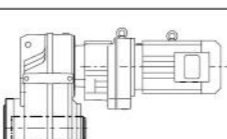
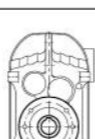
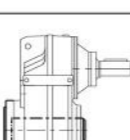
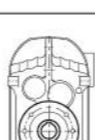

5 结构形式  
Mounting type:

|  |   |
|--|---|
| <b>EF</b><br>底脚安装平行轴斜齿轮减速机<br>Foot-mounted parallel shaft helical gear reductor  | <br>     |
| <b>EFAB</b><br>底脚空心轴安装平行轴斜齿轮减速机<br>Foot-mounted parallel shaft helical gear reductor with hollow shaft   | <br>     |
| <b>EFF</b><br>B5法兰安装平行轴斜齿轮减速机<br>Parallel shaft helical gear reductor in B5 flange-mounted version   | <br>     |
| <b>EFAF</b><br>B5法兰空心轴安装平行轴斜齿轮减速机<br>Parallel shaft helical gear reductor in B5 flange-mounted version with hollow shaft   | <br>   |
| <b>EFA</b><br>空心轴安装平行轴斜齿轮减速机<br>Parallel shaft helical gear reductor with hollow shaft   | <br> |
| <b>EFAZ</b><br>B14法兰空心轴安装平行轴斜齿轮减速机<br>Parallel shaft helical gear reductor in B14 flange-mounted version with hollow shaft   | <br> |
| <b>EF..ER</b><br>EF系列与ER..7系列组合减速机<br>Combination of EF series reductor and ER..7 series reductor  | <br> |
| <b>EF..S</b><br>轴输入型, 即配输入轴不配电动机的平行轴斜齿轮减速机<br>shaft-input style, in another word, parallel shaft helical gear reductor equipped with input shaft but without the motor | <br> |

6 型号说明  
Instructions for Models:

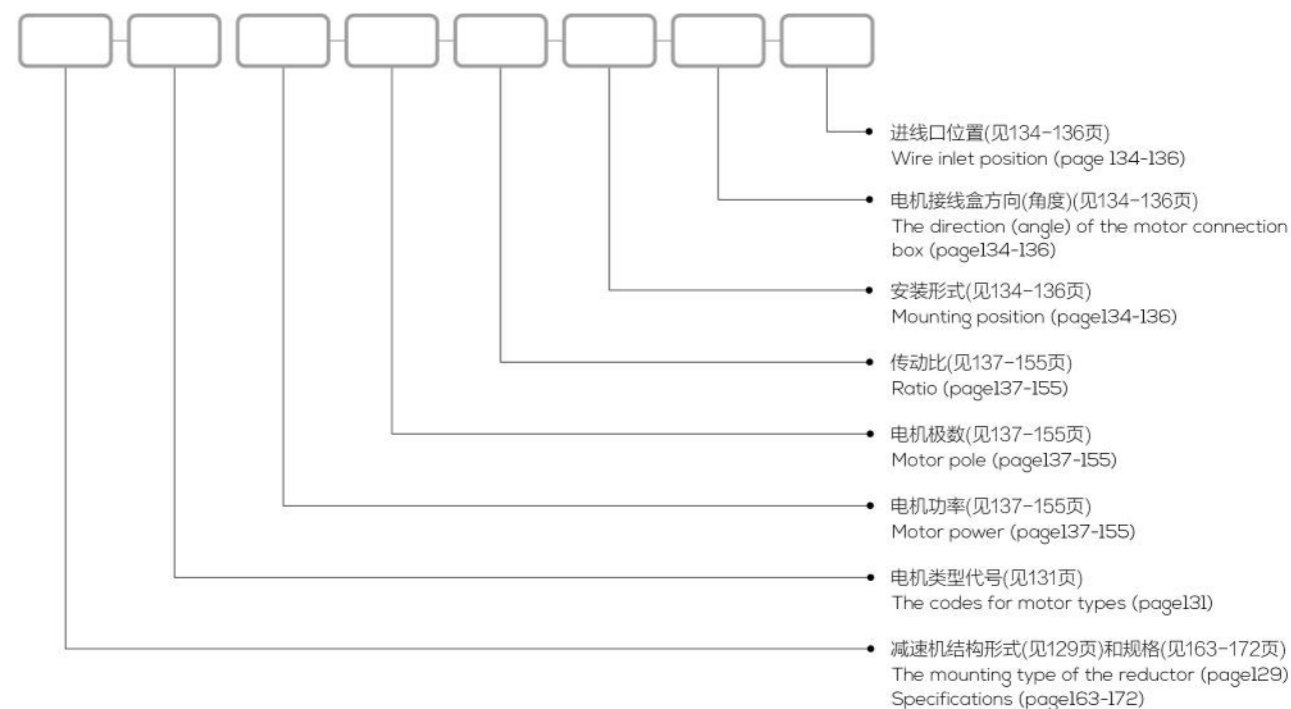

示例  
Sample

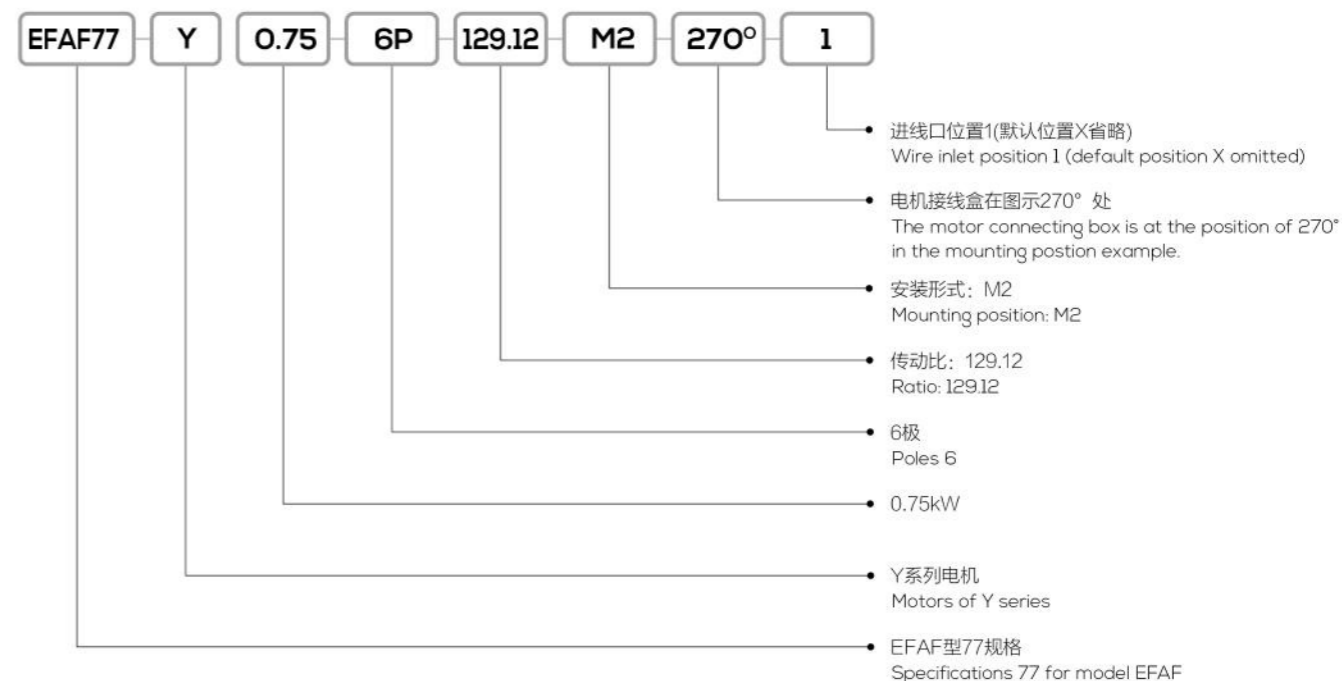



**注 Notes**

1. 轴输入型没有电动机的各项内容。
2. 无特别说明时Y系列电动机供货按IP54防护等级。
3. 不注明安装形式时, 按安装形式图(见134-136页)中M1安装形式供货。
4. 不注明接线盒角度时, 按安装形式图(见134-136页)中0度位置供货。

1. The shaft-input style is not equipped with any motor
2. Motors of Y series are supplied with protection grade of IP54 unless otherwise specified.
3. The mounting position of M1 as shown in the mounting position example (Page 134-136) is the default way when supplying unless otherwise specified.
4. 0° as shown in the mounting position example (Page 134-136) is the default connection box angle when supplying unless otherwise specified.

**电机类型代号  
Codes for Motor Types:**

|              |                              |            |                                 |            |                                  |
|--------------|------------------------------|------------|---------------------------------|------------|----------------------------------|
| <b>Y</b>     | Y系列<br>Y series              | <b>YB</b>  | 防爆电机<br>Flameproof Motor        | <b>Z</b>   | 直流电机<br>Direct Current Motor     |
| <b>YEJ</b>   | 制动电机<br>Brake Motor          | <b>YG</b>  | 辊道电机<br>Roll Motor              | <b>YVP</b> | 变频电机<br>Variable Frequency Motor |
| <b>YVPEJ</b> | 变频制动<br>Transduction braking | <b>YGP</b> | 变频辊道<br>Transduction roller way | <b>YZR</b> | 冶金起重<br>Metallurgy hoisting      |

**安装形式图释义  
Explanation of mounting position example**



**选型参数表释义  
Explanation of Parameter Selection List**

| 输出转速<br>Output speed<br>[r/min] | 输出转矩<br>Output torque<br>[Nm] | 传动比<br>Ratio<br>[i] | 使用系数<br>Service factor<br>[f <sub>s</sub> ] | 机型号<br>Type | 电机极数<br>Motor pole |
|---------------------------------|-------------------------------|---------------------|---|-------------|--------------------|
| <b>0.75kW</b>                   |                               |                     |   |             |                    |
| 25                              | 2810                          | 57.33               | 1.05  |             |                    |
| 28                              | 2530                          | 51.50               | 1.15  | EF 87       | 4                  |
| 32                              | 2270                          | 46.31               | 1.25  | EFA 87      | 4                  |
| 36                              | 1970                          | 40.19               | 1.40  | EFF 87      | 4                  |
| 41                              | 1770                          | 35.99               | 1.50  | EFAF87      | 4                  |
| 49                              | 1460                          | 29.86               | 1.70  |             |                    |

1. 选型参数表中的机型号可与该栏中的任一传动比搭配。
  2. 选型参数表中的参数也适用于EFAB、EFAZ、EFH、EFHB、EFHZ机型。
- 1.The machine types in the parameter selection list can match any transmission ratio in the column.  
2.The parameters in this list also fits model EFAB、EFAZ、EFH、EFHB、EFHZ.

**EF系列输入功率及最大扭矩  
Input power and maximum torque of EF series**

| 型号    | Type                   | EF37   | EF47        | EF57        | EF67        | EF77        |
|-------|------------------------|--|-------------|-------------|-------------|-------------|
| 结构形式  | Structure              | EF、EFA、EFF、EFAF、EFAZ、EFAB、EFH、EFHF、EFHZ、EFHB |             |             |             |             |
| 输入功率  | Input power rating(kw) | 0.12~3                                       | 0.12~3      | 0.12~5.5    | 0.18~5.5    | 0.37~11     |
| 传动比   | Ratio                  | 84~128.51                                    | 4.67~179.53 | 4.75~199.70 | 3.94~229.10 | 3.75~281.71 |
| 最大扭矩* | Maximum torque(Nm)     | 200  | 380         | 600         | 820         | 1500        |

| 型号    | Type                   | EF87   | EF97        | EF107       | EF127       | EF157        |
|-------|------------------------|--|-------------|-------------|-------------|--------------|
| 结构形式  | Structure              | EF、EFA、EFF、EFAF、EFAZ、EFAB、EFH、EFHF、EFHZ、EFHB |             |             |             |              |
| 输入功率  | Input power rating(kw) | 0.75~22                                      | 1.1~30      | 2.2~45      | 7.5~90      | 11~200       |
| 传动比   | Ratio                  | 3.70~273.43                                  | 3.80~276.99 | 4.91~251.75 | 4.99~174.86 | 11.92~267.43 |
| 最大扭矩* | Maximum torque(Nm)     | 3000   | 4300        | 7840        | 12000       | 18000        |

\*最大扭矩指该规格不同传动比对应的最大扭矩的最大值  
\*The maximum torque indicates the maximum value of maximum torque corresponding to different transmission ratios in this specification.

**EF系列主机重量表  
Main machine weight form of EF series**

|    |            |        |        |        |        |        |        |        |         |         |         |
|----|------------|--------|--------|--------|--------|--------|--------|--------|---------|---------|---------|
| 型号 | Type       | EF37   | EF47   | EF57   | EF67   | EF77   | EF87   | EF97   | EF107   | EF127   | EF157   |
| 重量 | Weight(kg) | 19     | 25     | 29     | 35     | 62.5   | 109    | 182    | 259     | 431     | 679     |
| 型号 | Type       | EFF37  | EFF47  | EFF57  | EFF67  | EFF77  | EFF87  | EFF97  | EFF107  | EFF127  | EFF157  |
| 重量 | Weight(kg) | 21     | 28     | 35     | 41     | 72.5   | 124    | 215    | 286     | 476     | 785     |
| 型号 | Type       | EFA37  | EFA47  | EFA57  | EFA67  | EFA77  | EFA87  | EFA97  | EFA107  | EFA127  | EFA157  |
| 重量 | Weight(kg) | 19     | 25     | 29     | 32     | 58.5   | 104    | 176    | 243     | 396     | 658     |
| 型号 | Type       | EFAF37 | EFAF47 | EFAF57 | EFAF67 | EFAF77 | EFAF87 | EFAF97 | EFAF107 | EFAF127 | EFAF157 |
| 重量 | Weight(kg) | 20     | 27     | 34     | 39     | 65.5   | 117    | 197    | 263     | 431     | 717     |

注:  
1)EFAZ、EFAT、EFAB、EFH、EFHZ、EFHT、EFHB与EFA主机重量近似。  
2)EFHF与EFAF主机重量近似。  
Note:  
1)The weight of main machine of EFAZ、EFAT、EFAB、EFH、EFHZ、EFHT、EFHB is similar to that of EFA.  
2)The weight of main machine of EFHF is similar to that of EFAF.



12 EF系列润滑油量表  
Lubricating oil quantity form of EF series

EF..

| 型号 Type | 润滑油量(升) Fill quantity in liters(L) |      |      |      |      |     |
|---------|------------------------------------|------|------|------|------|-----|
|         | M1                                 | M2   | M3   | M4   | M5   | M6  |
| EF37    | 1                                  | 1.2  | 0.7  | 1.2  | 1    | 1.1 |
| EF47    | 1.5                                | 1.8  | 1.1  | 1.9  | 1.5  | 1.7 |
| EF57    | 2.6                                | 3.7  | 2.1  | 3.5  | 2.8  | 2.9 |
| EF67    | 2.7                                | 3.8  | 1.9  | 3.8  | 2.9  | 3.2 |
| EF77    | 5                                  | 7.3  | 4.3  | 8    | 6    | 6.3 |
| EF87    | 10                                 | 13   | 7.7  | 13.8 | 10.8 | 11  |
| EF97    | 18.5                               | 22.5 | 12.6 | 25.2 | 18.5 | 20  |
| EF107   | 24.5                               | 32   | 19.5 | 37.5 | 27   | 27  |
| EF127   | 40.5                               | 55   | 34   | 61   | 46.5 | 47  |
| EF157   | 69                                 | 104  | 63   | 105  | 86   | 78  |

EFA... EFAF... EFAZ... EFAT... EFAB... EFH... EFHF... EFHZ... EFHT... EFHB..

| 型号 Type | 润滑油量(升) Fill quantity in liters(L) |      |      |      |      |      |
|---------|------------------------------------|------|------|------|------|------|
|         | M1                                 | M2   | M3   | M4   | M5   | M6   |
| EF..37  | 1                                  | 1.2  | 0.7  | 1.2  | 1    | 1.1  |
| EF..47  | 1.5                                | 1.8  | 1.1  | 1.9  | 1.5  | 1.7  |
| EF..57  | 2.7                                | 3.8  | 2.1  | 3.6  | 2.9  | 3    |
| EF..67  | 2.7                                | 3.8  | 1.9  | 3.8  | 2.9  | 3.2  |
| EF..77  | 5                                  | 7.3  | 4.3  | 8    | 6    | 6.3  |
| EF..87  | 10                                 | 13   | 7.7  | 13.8 | 10.8 | 11   |
| EF..97  | 18.5                               | 22.5 | 12.6 | 25   | 18.5 | 20   |
| EF..107 | 24.5                               | 32   | 19.5 | 37.5 | 27   | 27   |
| EF..127 | 39                                 | 55   | 34   | 61   | 45   | 46.5 |
| EF..157 | 68                                 | 103  | 62   | 104  | 85   | 77   |

EFF..

| 型号 Type | 润滑油量(升) Fill quantity in liters(L) |      |      |      |      |      |
|---------|------------------------------------|------|------|------|------|------|
|         | M1                                 | M2   | M3   | M4   | M5   | M6   |
| EFF37   | 1                                  | 1.2  | 0.7  | 1.3  | 1    | 1.1  |
| EFF47   | 1.6                                | 1.9  | 1.1  | 1.9  | 1.5  | 1.7  |
| EFF57   | 2.8                                | 3.8  | 2.1  | 3.7  | 2.9  | 3    |
| EFF67   | 2.7                                | 3.8  | 1.9  | 3.8  | 2.9  | 3.2  |
| EFF77   | 5.1                                | 7.3  | 4.3  | 8.1  | 6    | 6.3  |
| EFF87   | 10.3                               | 13.2 | 7.8  | 14.1 | 11   | 11.2 |
| EFF97   | 19                                 | 22.5 | 12.6 | 25.5 | 18.9 | 20.5 |
| EFF107  | 25.5                               | 32   | 19.5 | 38.5 | 27.5 | 28   |
| EFF127  | 41.5                               | 56   | 34   | 63   | 46.5 | 49   |
| EFF157  | 72                                 | 105  | 64   | 106  | 87   | 79   |

EF/EFAB37-157

安装形式图 Mounting position example

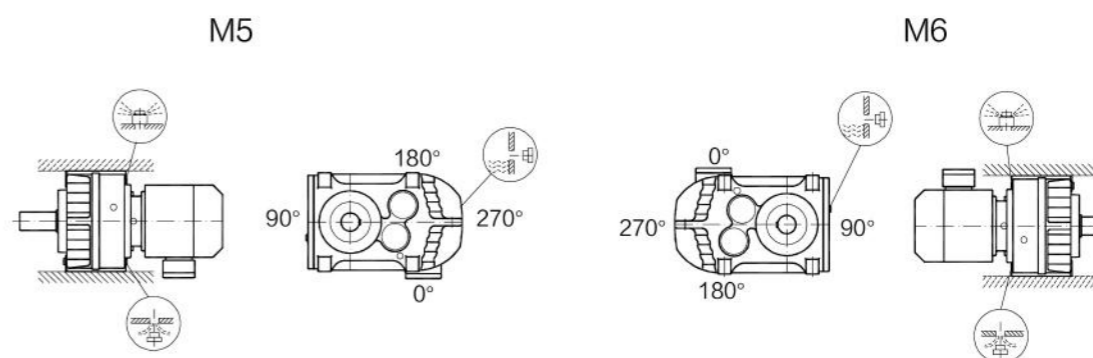
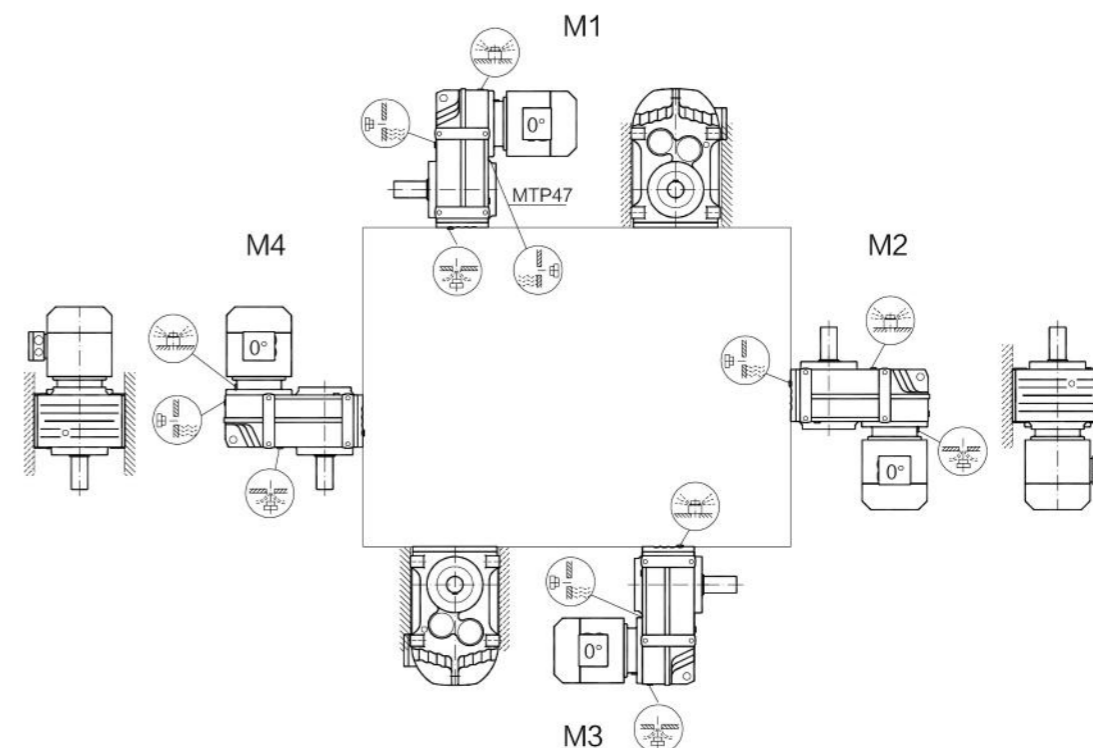
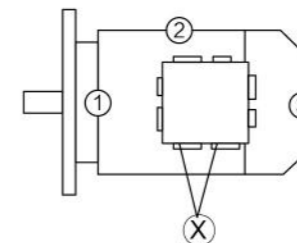
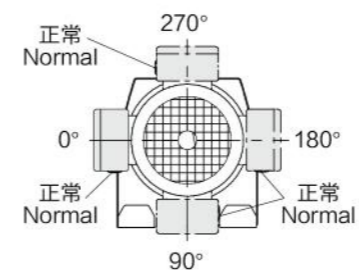



EFA37-157

安装形式图 Mounting position example

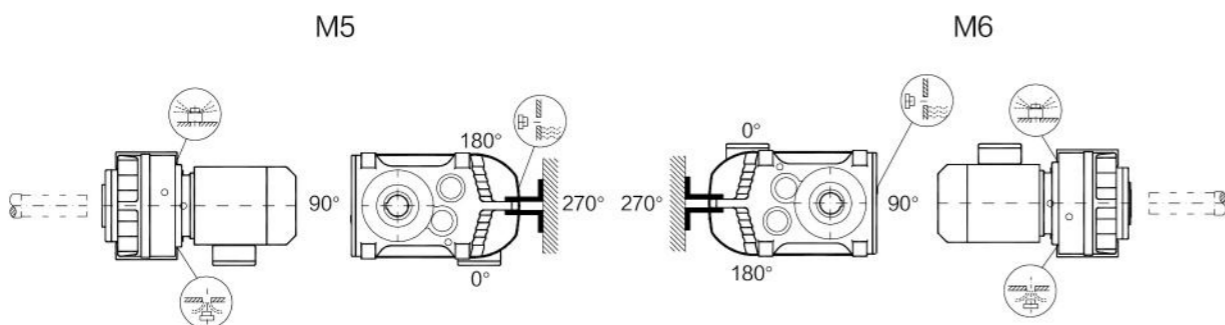
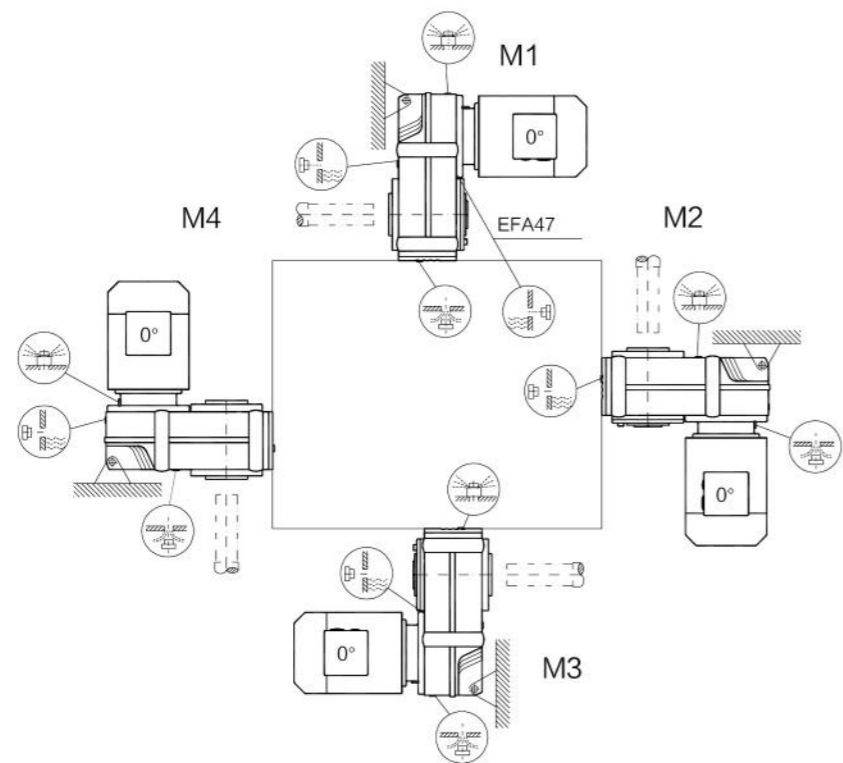
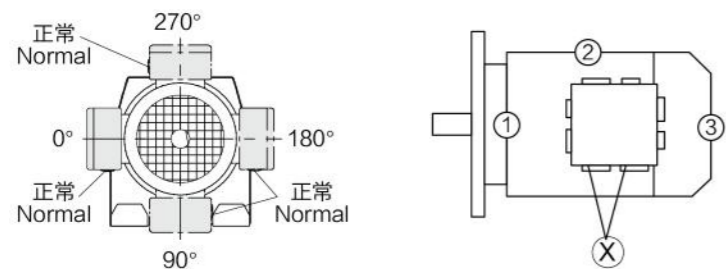

EFF/EFAF/EFAZ37-157

安装形式图 Mounting position example

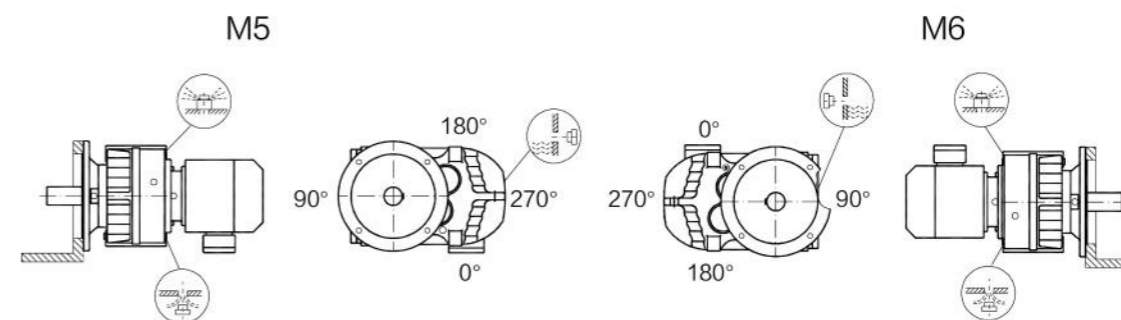
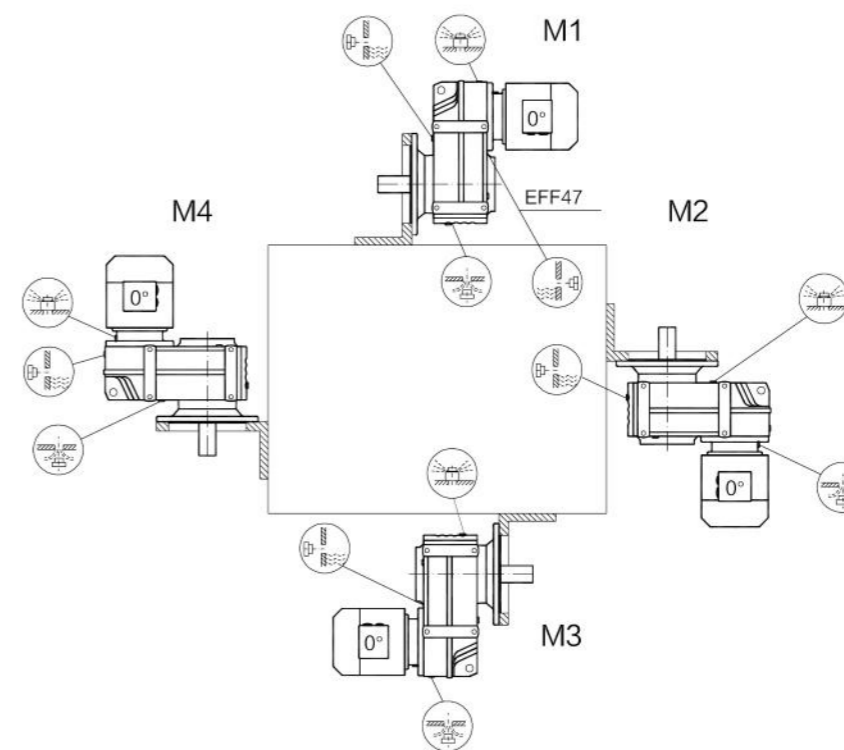
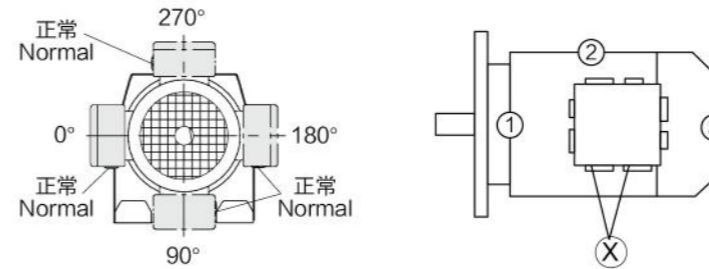



EF 系列恒功率选型参数表

Constant power model selection parameter form of EF series

Table with columns: Output speed, Output torque, Ratio, Service factor, Type, Motor pole. Rows categorized by power levels (0.12kW, 0.18kW, 0.25kW, 0.37kW, 0.55kW, 0.75kW, 1.1kW, 1.5kW).

Table with columns: Output speed, Output torque, Ratio, Service factor, Type, Motor pole. Rows categorized by power levels (0.12kW, 0.18kW, 0.25kW, 0.37kW, 0.55kW, 0.75kW, 1.1kW, 1.5kW).

Table with columns: Output speed, Output torque, Ratio, Service factor, Type, Motor pole. Rows categorized by power levels (0.12kW, 0.18kW, 0.25kW, 0.37kW, 0.55kW, 0.75kW, 1.1kW, 1.5kW).

Table with columns: Output speed, Output torque, Ratio, Service factor, Type, Motor pole. Rows categorized by power levels (0.18kW, 0.25kW, 0.37kW, 0.55kW, 0.75kW, 1.1kW, 1.5kW).



















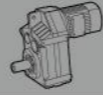

| 输出转速<br>Output speed | 输出转矩<br>Output torque | 传动比<br>Ratio | 使用系数<br>Service factor | 机型号<br>Type | 电机极数<br>Motor pole |
|----------------------|-----------------------|--------------|------------------------|-------------|--------------------|
| [r/min]              | [Nm]                  | (i)          | (f <sub>s</sub> )      |             |                    |
| <b>132kW</b>         |                       |              |                        |             |                    |
| 67                   | 18800                 | 22.16        | 0.95                   |             |                    |
| 75                   | 16800                 | 19.77        | 1.00                   | EF 157      | 4                  |
| 88                   | 14300                 | 16.85        | 1.25                   | EFA 157     | 4                  |
| 106                  | 11800                 | 13.96        | 1.45                   | EFF 157     | 4                  |
| 125                  | 10100                 | 11.92        | 1.60                   | EFAF157     | 4                  |
| <b>160kW</b>         |                       |              |                        |             |                    |
| 88                   | 17300                 | 16.85        | 1.05                   | EF 157      | 4                  |
| 106                  | 14400                 | 13.96        | 1.20                   | EFA 157     | 4                  |
| 125                  | 12300                 | 11.92        | 1.30                   | EFF 157     | 4                  |
|                      |                       |              |                        | EFAF157     | 4                  |
| <b>200kW</b>         |                       |              |                        |             |                    |
| 88                   | 21700                 | 16.85        | 0.85                   | EF 157      | 4                  |
| 106                  | 18000                 | 13.96        | 0.95                   | EFA 157     | 4                  |
| 125                  | 15300                 | 11.92        | 1.05                   | EFF 157     | 4                  |
|                      |                       |              |                        | EFAF157     | 4                  |

| 输出转速<br>Output speed | 输出转矩<br>Output torque | 传动比<br>Ratio | 使用系数<br>Service factor | 机型号<br>Type | 电机极数<br>Motor pole |
|----------------------|-----------------------|--------------|------------------------|-------------|--------------------|
| [r/min]              | [Nm]                  | (i)          | (f <sub>s</sub> )      |             |                    |

**EF系列恒扭矩选型参数表**

Constant torque model selection parameter form of EF series

| 输出转速<br>Output speed | 传动比<br>Ratio | 机型号<br>Type | 电机功率<br>Power |
|----------------------|--------------|-------------|---------------|
| [r/min]              | (i)          |             | [kW]/4P       |
| <b>200Nm</b>         |              |             |               |
| 0.17                 | 8193         |             |               |
| 0.20                 | 6909         |             |               |
| 0.21                 | 6760         |             |               |
| 0.24                 | 5756         |             |               |
| 0.28                 | 4962         |             |               |
| 0.32                 | 4336         |             |               |
| 0.36                 | 3875         |             |               |
| 0.41                 | 3392         |             |               |
| 0.47                 | 2965         |             |               |
| 0.54                 | 2587         |             |               |
| 0.61                 | 2284         |             |               |
| 0.70                 | 1996         |             |               |
| 0.72                 | 1929         | EF 37ER17   | 0.12          |
| 0.83                 | 1679         | EFA 37ER17  |               |
| 0.90                 | 1550         | EFF 37ER17  |               |
| 1.0                  | 1356         | EFAF37ER17  |               |
| 1.2                  | 1180         |             |               |
| 1.3                  | 1036         |             |               |
| 1.5                  | 914          |             |               |
| 1.7                  | 808          |             |               |
| 2.0                  | 698          |             |               |
| 2.3                  | 616          |             |               |
| 2.6                  | 544          |             |               |
| 3.0                  | 466          |             |               |
| 3.4                  | 411          |             |               |
| 3.8                  | 364          |             |               |
| 4.3                  | 326          |             |               |
| 4.9                  | 285          |             |               |
| 5.6                  | 250          |             |               |
| 6.3                  | 219          |             |               |
| 7.5                  | 186          |             |               |
| 8.3                  | 167          |             |               |
| 9.6                  | 145          |             |               |
| 11                   | 129          |             |               |
| <b>400Nm</b>         |              |             |               |
| 0.11                 | 12637        |             |               |
| 0.14                 | 10296        |             |               |
| 0.14                 | 9651         |             |               |
| 0.16                 | 8517         |             |               |
| 0.18                 | 7550         |             |               |
| 0.21                 | 6562         |             |               |
| 0.24                 | 5734         |             |               |
| 0.27                 | 5084         |             |               |
| 0.31                 | 4418         |             |               |
| 0.36                 | 3910         |             |               |
| 0.40                 | 3445         |             |               |
| 0.47                 | 2946         |             |               |
| 0.53                 | 2599         |             |               |
| 0.59                 | 2371         | EF 47ER17   | 0.12          |
| 0.62                 | 2226         | EFA 47ER17  |               |
| 0.68                 | 2044         | EFF 47ER17  |               |
| 0.78                 | 1789         | EFAF47ER17  |               |
| 0.89                 | 1561         |             |               |
| 1.0                  | 1378         |             |               |
| 1.2                  | 1178         |             |               |
| 1.3                  | 1063         |             |               |
| 1.5                  | 928          |             |               |
| 1.7                  | 822          |             |               |
| 2.0                  | 699          |             |               |
| 2.2                  | 622          |             |               |

| 输出转速<br>Output speed | 传动比<br>Ratio | 机型号<br>Type | 电机功率<br>Power |      |
|----------------------|--------------|-------------|---------------|------|
| [r/min]              | (i)          |             | [kW]/4P       |      |
| <b>400Nm</b>         |              |             |               |      |
| 2.7                  | 518          |             | 0.18          |      |
| 2.8                  | 493          |             |               |      |
| 3.2                  | 429          |             |               |      |
| 3.6                  | 383          |             |               |      |
|                      |              |             |               |      |
| 4.1                  | 335          | EF 47ER17   | 0.25          |      |
| 4.7                  | 295          | EFA 47ER17  |               |      |
| 5.5                  | 251          | EFF 47ER17  |               |      |
|                      |              | EFAF47ER17  | 0.37          |      |
| 6.3                  | 219          |             |               |      |
| 7.4                  | 188          |             |               |      |
| 7.8                  | 179          |             | 0.55          |      |
| 9.3                  | 149          |             |               |      |
| 11                   | 131          |             |               |      |
| <b>600Nm</b>         |              |             |               |      |
| 0.09                 | 14831        |             | 0.12          |      |
| 0.10                 | 13604        |             |               |      |
| 0.11                 | 12601        |             |               |      |
| 0.12                 | 11251        |             |               |      |
| 0.14                 | 9986         |             |               |      |
| 0.16                 | 8786         |             |               |      |
| 0.18                 | 7908         |             |               |      |
| 0.20                 | 6913         |             |               |      |
| 0.23                 | 6102         |             |               |      |
| 0.26                 | 5289         |             |               |      |
| 0.30                 | 4654         |             |               |      |
| 0.34                 | 4039         |             |               |      |
| 0.39                 | 3565         |             |               |      |
| 0.44                 | 3160         |             |               |      |
| 0.49                 | 2854         | EF 57ER37   |               | 0.12 |
| 0.54                 | 2576         | EFA 57ER37  |               |      |
| 0.61                 | 2266         | EFF 57ER37  |               |      |
| 0.69                 | 2012         | EFAF57ER37  |               |      |
| 0.78                 | 1791         |             |               |      |
| 0.86                 | 1617         |             |               |      |
| 0.98                 | 1423         |             |               |      |
| 1.1                  | 1244         |             |               |      |
| 1.3                  | 1066         |             |               |      |
| 1.5                  | 949          |             |               |      |
| 1.6                  | 856          |             |               |      |
| 1.9                  | 749          |             |               |      |
| 2.1                  | 659          |             |               |      |
| 2.5                  | 549          |             |               |      |
| 2.9                  | 483          |             |               |      |
| 3.3                  | 426          |             |               |      |
| 3.6                  | 382          |             |               |      |
| 4.2                  | 330          |             |               |      |
| 4.7                  | 298          |             |               |      |
| 5.3                  | 262          |             |               |      |
| 6.2                  | 226          |             |               |      |
| 7.0                  | 200          |             |               |      |
| 8.2                  | 170          |             |               |      |
| 9.1                  | 152          |             |               |      |
| 10                   | 134          |             |               |      |

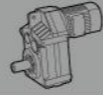

| 输出转速<br>Output speed<br>[r/min] | 传动比<br>Ratio<br>(i) | 机型号<br>Type   | 电机功率<br>Power<br>[kW]/4P |
|---------------------------------|---------------------|---|--------------------------|
| <b>820Nm</b>                    |                     |   |                          |
| 0.07                            | 19207               | EF 67ER37<br>EFA 67ER37<br>EFF 67ER37<br>EFAF67ER37 | 0.12                     |
| 0.08                            | 17618               |   |                          |
| 0.09                            | 15000               |   |                          |
| 0.11                            | 12933               |   |                          |
| 0.12                            | 11486               |   |                          |
| 0.14                            | 10224               |   |                          |
| 0.16                            | 8937                |   |                          |
| 0.17                            | 7945                |   |                          |
| 0.20                            | 7099                |   |                          |
| 0.23                            | 6083                |   |                          |
| 0.26                            | 5352                |   |                          |
| 0.30                            | 4667                |   |                          |
| 0.34                            | 4093                |   |                          |
| 0.39                            | 3574                |   |                          |
| 0.44                            | 3134                |   |                          |
| 0.50                            | 2757                |   |                          |
| 0.56                            | 2472                |   |                          |
| 0.42                            | 3317                |   | 0.12                     |
| 0.46                            | 3011                |   |                          |
| 0.52                            | 2669                |   |                          |
| 0.59                            | 2351                |   |                          |
| 0.65                            | 2130                |   |                          |
| 0.76                            | 1829                |   |                          |
| 0.87                            | 1605                |   |                          |
| 0.95                            | 1464                |   |                          |
| 1.1                             | 1252                |   |                          |
| 1.2                             | 1128                | 0.18  |                          |
| 1.4                             | 969                 |   |                          |
| 1.6                             | 859                 |   |                          |
| 1.9                             | 727                 | 0.25  |                          |
| 2.2                             | 639                 |   |                          |
| 2.6                             | 539                 |   |                          |
| 0.74                            | 1885                | 0.12  |                          |
| 2.8                             | 497                 | 0.25  |                          |
| 3.1                             | 449                 | 0.37  |                          |
| 3.6                             | 385                 |   |                          |
| 4.1                             | 339                 |   |                          |
| 4.7                             | 296                 | 0.55  |                          |
| 5.3                             | 262                 |   |                          |
| 5.9                             | 234                 |   |                          |
| 7.0                             | 200                 | 0.75  |                          |
| <b>1500Nm</b>                   |                     |   |                          |
| 0.07                            | 19180               | EF 77ER37<br>EFA 77ER37<br>EFF 77ER37<br>EFAF77ER37 | 0.12                     |
| 0.08                            | 17592               |   |                          |
| 0.09                            | 15967               |   |                          |
| 0.09                            | 14978               |   |                          |
| 0.10                            | 13594               |   |                          |
| 0.12                            | 12049               |   |                          |
| 0.13                            | 10925               |   |                          |
| 0.14                            | 9683                |   |                          |
| 0.16                            | 8464                |   |                          |
| 0.18                            | 7519                |   |                          |
| 0.21                            | 6581                |   |                          |
| 0.24                            | 5807                |   |                          |
| 0.27                            | 5058                |   |                          |
| 0.31                            | 4494                |   |                          |
| 0.36                            | 3832                |   |                          |
| 0.41                            | 3362                |   |                          |
| 0.47                            | 2987                |   |                          |
| 0.53                            | 2611                |   |                          |
| 0.60                            | 2315                |   |                          |

| 输出转速<br>Output speed<br>[r/min] | 传动比<br>Ratio<br>(i) | 机型号<br>Type   | 电机功率<br>Power<br>[kW]/4P |
|---------------------------------|---------------------|---|--------------------------|
| <b>1500Nm</b>                   |                     |   |                          |
| 0.68                            | 2056                | EF 77ER37<br>EFA 77ER37<br>EFF 77ER37<br>EFAF77ER37 | 0.18                     |
| 0.81                            | 1711                |   | 0.18                     |
| 0.90                            | 1543                |   |                          |
| 1.0                             | 1354                |   |                          |
| 1.2                             | 1203                |   | 0.25                     |
| 1.3                             | 1057                |   |                          |
| 1.5                             | 913                 |   | 0.37                     |
| 1.7                             | 810                 |   |                          |
| 2.0                             | 710                 |   |                          |
| 2.3                             | 615                 |   | 0.55                     |
| 2.6                             | 538                 |   |                          |
| 2.9                             | 480                 |   |                          |
| 3.4                             | 410                 |   |                          |
| 3.8                             | 370                 | 0.75  |                          |
| 4.3                             | 324                 |   |                          |
| <b>3000Nm</b>                   |                     |   |                          |
| 0.06                            | 22977               | EF 87ER57<br>EFA 87ER57<br>EFF 87ER57<br>EFAF87ER57 | 0.12                     |
| 0.07                            | 20766               |   |                          |
| 0.08                            | 18185               |   |                          |
| 0.09                            | 15831               |   |                          |
| 0.10                            | 14017               |   |                          |
| 0.11                            | 12170               |   |                          |
| 0.13                            | 10424               |   |                          |
| 0.15                            | 9359                |   |                          |
| 0.17                            | 8061                |   |                          |
| 0.19                            | 7156                |   |                          |
| 0.22                            | 6280                |   |                          |
| 0.25                            | 5501                |   |                          |
| 0.28                            | 4985                |   |                          |
| 0.33                            | 4189                |   | 0.18                     |
| 0.38                            | 3700                |   |                          |
| 0.43                            | 3207                |   | 0.18                     |
| 0.48                            | 2926                |   |                          |
| 0.55                            | 2521                |   | 0.25                     |
| 0.63                            | 2200                |   |                          |
| 0.71                            | 1951                |   |                          |
| 0.81                            | 1715                | 0.37  |                          |
| 0.93                            | 1500                |   |                          |
| 1.1                             | 1302                |   |                          |
| 1.2                             | 1150                | 0.55  |                          |
| 1.4                             | 1008                |   |                          |
| 1.6                             | 895                 |   |                          |
| 1.8                             | 779                 | 0.75  |                          |
| 2.1                             | 677                 |   |                          |
| 2.3                             | 611                 | 1.1   |                          |
| 2.8                             | 507                 |   |                          |
| 3.1                             | 453                 |   |                          |
| 4.1                             | 340                 | 1.5   |                          |

| 输出转速<br>Output speed<br>[r/min] | 传动比<br>Ratio<br>(i) | 机型号<br>Type   | 电机功率<br>Power<br>[kW]/4P |
|---------------------------------|---------------------|---|--------------------------|
| <b>4300Nm</b>                   |                     |   |                          |
| 0.07                            | 20799               | EF 97ER57<br>EFA 97ER57<br>EFF 97ER57<br>EFAF97ER57     | 0.12                     |
| 0.08                            | 18233               |   |                          |
| 0.09                            | 15467               |   |                          |
| 0.10                            | 14046               |   |                          |
| 0.11                            | 12329               |   |                          |
| 0.13                            | 10933               |   |                          |
| 0.15                            | 9453                |   |                          |
| 0.17                            | 8320                |   |                          |
| 0.19                            | 7318                |   |                          |
| 0.22                            | 6397                |   |                          |
| 0.25                            | 5624                |   |                          |
| 0.28                            | 4937                |   |                          |
| 0.32                            | 4355                |   |                          |
| 0.36                            | 3863                |   | 0.18                     |
| 0.41                            | 3361                |   | 0.25                     |
| 0.48                            | 2895                |   |                          |
| 0.55                            | 2547                |   | 0.37                     |
| 0.62                            | 2249                |   |                          |
| 0.70                            | 1979                |   |                          |
| 0.81                            | 1722                | 0.55  |                          |
| 0.91                            | 1532                |   |                          |
| 1.0                             | 1327                |   |                          |
| 1.2                             | 1173                | 0.75  |                          |
| 1.4                             | 1025                |   |                          |
| 1.6                             | 903                 |   |                          |
| 1.8                             | 797                 | 1.1   |                          |
| 2.0                             | 690                 |   |                          |
| 2.3                             | 603                 |   |                          |
| 2.6                             | 534                 | 1.5   |                          |
| 3.0                             | 468                 |   |                          |
| 3.5                             | 407                 |   |                          |
| 3.9                             | 362                 | 2.2   |                          |
| 5.1                             | 280                 |   |                          |
| 5.8                             | 246                 | 3   |                          |
| <b>7680Nm</b>                   |                     |   |                          |
| 0.05                            | 25371               | EF 107ER77<br>EFA 107ER77<br>EFF 107ER77<br>EFAF107ER77 | 0.12                     |
| 0.06                            | 21656               |   |                          |
| 0.07                            | 18998               |   |                          |
| 0.08                            | 16892               |   |                          |
| 0.09                            | 14724               |   |                          |
| 0.12                            | 11398               |   |                          |
| 0.14                            | 10009               |   |                          |
| 0.16                            | 8452                |   |                          |
| 0.18                            | 7630                |   |                          |
| 0.21                            | 6717                |   |                          |
| 0.23                            | 5944                |   |                          |
| 0.27                            | 5235                |   |                          |
| 0.30                            | 4645                |   | 0.25                     |
| 0.35                            | 4020                |   |                          |
| 0.39                            | 3564                |   |                          |
| 0.45                            | 3118                |   | 0.37                     |
| 0.51                            | 2724                |   |                          |
| 0.58                            | 2377                |   |                          |

| 输出转速<br>Output speed<br>[r/min] | 传动比<br>Ratio<br>(i) | 机型号<br>Type   | 电机功率<br>Power<br>[kW]/4P |
|---------------------------------|---------------------|---|--------------------------|
| <b>7680Nm</b>                   |                     |   |                          |
| 0.67                            | 2080                | EF 107ER77<br>EFA 107ER77<br>EFF 107ER77<br>EFAF107ER77 | 0.75                     |
| 0.76                            | 1831                |   |                          |
| 0.88                            | 1596                |   | 1.1                      |
| 0.99                            | 1416                |   |                          |
| 1.1                             | 1235                |   |                          |
| 1.3                             | 1084                |   | 1.5                      |
| 1.5                             | 956                 |   |                          |
| 1.7                             | 848                 |   | 2.2                      |
| 1.9                             | 746                 |   |                          |
| 2.2                             | 641                 |   |                          |
| 2.6                             | 555                 | 3   |                          |
| 2.9                             | 492                 |   |                          |
| 3.3                             | 436                 |   |                          |
| 3.9                             | 370                 | 4   |                          |
| 4.3                             | 333                 |   |                          |
| <b>12000Nm</b>                  |                     |   |                          |
| 0.06                            | 24541               | EF 127ER77<br>EFA 127ER77<br>EFF 127ER77<br>EFAF127ER77 | 0.12                     |
| 0.06                            | 22076               |   |                          |
| 0.07                            | 18792               |   | 0.18                     |
| 0.08                            | 16533               |   |                          |
| 0.09                            | 14873               |   |                          |
| 0.11                            | 12997               |   |                          |
| 0.12                            | 11458               |   |                          |
| 0.14                            | 10063               |   |                          |
| 0.16                            | 8853                |   |                          |
| 0.18                            | 7520                |   | 0.37                     |
| 0.21                            | 6735                |   |                          |
| 0.23                            | 5926                |   |                          |
| 0.27                            | 5128                |   | 0.55                     |
| 0.31                            | 4525                |   |                          |
| 0.36                            | 3908                |   |                          |
| 0.40                            | 3451                |   |                          |
| 0.46                            | 3032                |   | 0.75                     |
| 0.54                            | 2575                |   |                          |
| 0.59                            | 2372                | 1.1   |                          |
| 0.70                            | 2011                |   |                          |
| 0.79                            | 1774                |   |                          |
| 0.89                            | 1578                | 1.5   |                          |
| 1.0                             | 1399                |   |                          |
| 1.2                             | 1218                |   |                          |
| 1.3                             | 1068                | 2.2   |                          |
| 1.5                             | 929                 |   |                          |
| 1.7                             | 825                 |   |                          |
| 2.0                             | 717                 | 3   |                          |
| 2.2                             | 654                 |   |                          |
| 2.6                             | 555                 |   |                          |
| 3.0                             | 487                 | 4   |                          |
| 3.3                             | 430                 |   |                          |
| 3.8                             | 381                 | 5.5   |                          |



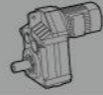

EF

| 输出转速<br>Output speed<br>[r/min]  | 传动比<br>Ratio<br>(i)   | 机型号<br>Type   | 电机功率<br>Power<br>[kW]/4P                                |      |      |
|--|---|---|---|------|------|
| <b>12000Nm</b>   |   |   |   |      |      |
| 3.0<br>3.5<br>3.9  | 486<br>412<br>374   | EF 127ER87<br>EFA 127ER87<br>EFF 127ER87<br>EFAF127ER87 | 5.5   |      |      |
| 4.6<br>4.9   | 314<br>296  |   |   | 7.5  |      |
| 5.6<br>6.5<br>7.3  | 261<br>225<br>199   |   |   |      | 11   |
| <b>18000Nm</b>   |   |   |   |      |      |
| 0.04<br>0.05<br>0.06<br>0.07<br>0.08<br>0.09<br>0.10<br>0.12<br>0.14<br>0.16<br>0.17<br>0.20<br>0.22 | 31544<br>26042<br>23766<br>20361<br>17717<br>16282<br>13555<br>12060<br>10088<br>8903<br>8143<br>7060<br>6304 |   | EF 157ER97<br>EFA 157ER97<br>EFF 157ER97<br>EFAF157ER97 | 0.55 |      |
| 0.26<br>0.29<br>0.33   | 5342<br>4840<br>4152  |   |   |      | 0.75 |
| 0.39<br>0.44<br>0.50   | 3599<br>3202<br>2790  | 1.1   |   |      |      |
| 0.99   | 1432  |   |   |      |      |
| 0.59<br>0.65   | 2393<br>2154  | 1.5   |   |      |      |
| 0.73<br>0.85   | 1951<br>1670  |   |   |      |      |
| 1.1  | 1326  | 3   |   |      |      |
| 1.5<br>1.7<br>1.9  | 940<br>851<br>772   |   |   |      |      |
| 2.1<br>2.5   | 674<br>574  | 5.5   |   |      |      |
| 2.9<br>3.3   | 502<br>437  |   |   |      |      |
| 4.2<br>4.9<br>5.3  | 348<br>301<br>275   | 11  |   |      |      |
| 6.3<br>7.3   | 230<br>201  |   |   |      |      |
| 7.4  | 198   | 18.5  |   |      |      |

| 输出转速<br>Output speed<br>[r/min] | 传动比<br>Ratio<br>(i) | 机型号<br>Type | 电机功率<br>Power<br>[kW]/4P |
|---------------------------------|---------------------|-------------|--------------------------|
|                                 |                     |             |                          |

EF系列轴输入型选型参数表 (n=1400 r/min)

Model selection parameter form of shaft input type of EF series(n=1400 r/min)

| 传动比<br>Ratio<br>(i)   | 输出转速<br>Output speed<br>[r/min]  | 许用扭矩<br>Permissible<br>Torque<br>[Nm]  | 额定功率<br>Nominal Power<br>Ratings<br>[kW]   | 机型号<br>Type |     |                                     |     |     |                                     |     |
|---|--|--|--|-------------|-----|-------------------------------------|-----|-----|-------------------------------------|-----|
| 128.51<br>117.88<br>100.36<br>86.53<br>80.65<br>70.50<br>66.09<br>58.32<br>54.54<br>51.70   | 11<br>12<br>14<br>16<br>17<br>20<br>21<br>24<br>26<br>27   | 200<br>200<br>200<br>200<br>200<br>200<br>200<br>200<br>200<br>200   | 0.25<br>0.27<br>0.32<br>0.37<br>0.40<br>0.46<br>0.49<br>0.55<br>0.59<br>0.62   | AD1         |     |                                     |     |     |                                     |     |
| 47.02<br>43.83<br>38.31<br>35.91<br>31.69<br>28.10<br>23.88   | 30<br>32<br>37<br>39<br>44<br>50<br>59   | 200<br>200<br>200<br>200<br>200<br>200<br>200  | 0.69<br>0.74<br>0.84<br>0.90<br>1.0<br>1.1<br>1.3  |             | AD2 |                                     |     |     |                                     |     |
| 23.63<br>20.57<br>19.27<br>17.03<br>15.81<br>14.33<br>12.87<br>11.08<br>10.42<br>8.97<br>8.01<br>7.57<br>6.86<br>6.16<br>5.31<br>4.99<br>4.30<br>3.84 | 59<br>68<br>73<br>82<br>89<br>98<br>109<br>126<br>134<br>156<br>175<br>185<br>204<br>227<br>264<br>280<br>326<br>365 | 200<br>200<br>200<br>200<br>200<br>200<br>200<br>190<br>185<br>175<br>170<br>145<br>140<br>135<br>125<br>120<br>110<br>105 | 1.3<br>1.5<br>1.6<br>1.8<br>2.0<br>2.2<br>2.4<br>2.7<br>2.8<br>3.0<br>3.3<br>3.0<br>3.2<br>3.4<br>3.7<br>3.7<br>4.0<br>4.3 |             |     | EF 37<br>EFA 37<br>EFF 37<br>EFAF37 |     |     |                                     |     |
| 179.53<br>165.06<br>141.22<br>122.41<br>114.41<br>98.90<br>84.03<br>75.03<br>64.08  | 7.8<br>8.5<br>9.9<br>11<br>12<br>14<br>17<br>19<br>22  | 400<br>400<br>400<br>400<br>400<br>400<br>400<br>400<br>400  | 0.36<br>0.39<br>0.46<br>0.53<br>0.56<br>0.65<br>0.77<br>0.86<br>1.0  |             |     |                                     | AD1 |     |                                     |     |
| 63.37<br>54.78<br>46.54<br>41.56<br>35.50<br>33.24<br>28.00   | 22<br>26<br>30<br>34<br>39<br>42<br>50   | 400<br>400<br>400<br>400<br>400<br>400<br>400  | 1.0<br>1.2<br>1.4<br>1.6<br>1.8<br>1.9<br>2.3  |             |     |                                     |     | AD2 |                                     |     |
| 29.04<br>27.27<br>24.21<br>20.53<br>18.54<br>16.31<br>15.40<br>13.11<br>11.92<br>10.32<br>9.28<br>8.38<br>7.37<br>6.96<br>5.93<br>5.39<br>4.67        | 48<br>51<br>58<br>68<br>76<br>86<br>91<br>107<br>117<br>136<br>151<br>167<br>190<br>201<br>236<br>260<br>300         | 400<br>400<br>400<br>400<br>400<br>400<br>400<br>400<br>400<br>380<br>250<br>250<br>230<br>225<br>200<br>191<br>173        | 2.1<br>2.3<br>2.6<br>3.0<br>3.4<br>3.8<br>4.1<br>4.8<br>5.2<br>5.7<br>4.2<br>4.7<br>4.9<br>5.0<br>5.3<br>5.5<br>5.8        |             |     |                                     |     |     | EF 47<br>EFA 47<br>EFF 47<br>EFAF47 |     |
| 29.04<br>27.27<br>24.21<br>20.53<br>18.54<br>16.31<br>15.40<br>13.11<br>11.92<br>10.32<br>9.28<br>8.38<br>7.37<br>6.96<br>5.93<br>5.39<br>4.67        | 48<br>51<br>58<br>68<br>76<br>86<br>91<br>107<br>117<br>136<br>151<br>167<br>190<br>201<br>236<br>260<br>300         | 400<br>400<br>400<br>400<br>400<br>400<br>400<br>400<br>400<br>380<br>250<br>250<br>230<br>225<br>200<br>191<br>173        | 2.1<br>2.3<br>2.6<br>3.0<br>3.4<br>3.8<br>4.1<br>4.8<br>5.2<br>5.7<br>4.2<br>4.7<br>4.9<br>5.0<br>5.3<br>5.5<br>5.8        |             |     |                                     |     |     |                                     | AD2 |

| 传动比<br>Ratio<br>(i)   | 输出转速<br>Output speed<br>[r/min]  | 许用扭矩<br>Permissible<br>Torque<br>[Nm]   | 额定功率<br>Nominal Power<br>Ratings<br>[kW]   | 机型号<br>Type |                                     |     |     |     |
|---|--|---|--|-------------|-------------------------------------|-----|-----|-----|
| 199.70<br>183.60<br>157.09<br>136.16<br>127.27<br>110.01<br>93.47<br>83.46<br>76.07<br>71.10<br>61.46<br>52.22<br>46.62<br>39.82<br>37.30<br>31.42                    | 7.0<br>7.6<br>8.9<br>10<br>11<br>13<br>15<br>17<br>18<br>20<br>23<br>27<br>30<br>35<br>38<br>45                            | 600<br>600<br>600<br>600<br>600<br>600<br>600<br>600<br>600<br>600<br>600<br>600<br>600<br>600<br>600<br>590                      | 0.48<br>0.53<br>0.62<br>0.71<br>0.76<br>0.88<br>1.0<br>1.2<br>1.3<br>1.4<br>1.6<br>1.9<br>2.1<br>2.4<br>2.6<br>3.0                     | AD2         |                                     |     |     |     |
| 40.13<br>34.24<br>29.94<br>28.12<br>24.96   | 35<br>41<br>47<br>50<br>56   | 265<br>440<br>415<br>410<br>575   | 1.0<br>2.0<br>2.2<br>2.3<br>3.6  |             | EF 57<br>EFA 57<br>EFF 57<br>EFAF57 |     |     |     |
| 21.17<br>19.11<br>16.81<br>15.88<br>13.52<br>12.29<br>10.64<br>9.45<br>8.54<br>7.51<br>7.09<br>6.04<br>5.49<br>4.75   | 66<br>73<br>83<br>88<br>104<br>114<br>132<br>148<br>164<br>186<br>197<br>232<br>255<br>295                                 | 600<br>600<br>600<br>600<br>600<br>600<br>600<br>310<br>310<br>400<br>390<br>355<br>335<br>305                                    | 4.4<br>4.9<br>5.6<br>5.9<br>6.9<br>7.6<br>8.8<br>5.1<br>5.7<br>8.3<br>8.6<br>9.2<br>9.5<br>10.0  |             |                                     | AD3 |     |     |
| 229.10<br>195.48<br>170.93<br>160.50<br>142.47<br>120.84<br>109.09<br>95.98<br>90.63<br>85.94<br>76.29<br>64.71<br>58.42<br>51.40<br>48.53<br>41.32<br>37.55<br>32.53 | 6.1<br>7.2<br>8.2<br>8.7<br>9.8<br>12<br>13<br>15<br>15<br>16<br>18<br>22<br>24<br>27<br>29<br>34<br>37<br>43              | 820<br>820<br>820<br>820<br>820<br>820<br>820<br>820<br>820<br>820<br>820<br>820<br>820<br>820<br>820<br>820<br>780<br>740        | 0.58<br>0.68<br>0.77<br>0.82<br>0.93<br>1.1<br>1.2<br>1.4<br>1.5<br>1.5<br>1.7<br>2.0<br>2.3<br>2.6<br>2.7<br>3.2<br>3.3<br>3.7        |             |                                     |     | AD2 |     |
| 32.28   | 43   | 590   | 2.9  |             |                                     |     |     | AD2 |
| 28.79<br>24.61<br>22.33<br>19.80<br>18.76<br>16.42<br>14.79<br>12.98<br>11.45<br>10.15<br>9.00<br>8.67<br>8.53<br>7.46<br>6.73<br>5.90<br>5.21<br>4.62<br>3.94        | 49<br>57<br>63<br>71<br>75<br>85<br>95<br>108<br>122<br>138<br>156<br>162<br>164<br>188<br>208<br>237<br>269<br>303<br>355 | 820<br>820<br>820<br>820<br>820<br>820<br>820<br>820<br>800<br>745<br>450<br>670<br>440<br>410<br>385<br>355<br>330<br>305<br>275 | 4.4<br>5.2<br>5.7<br>6.5<br>6.8<br>7.8<br>8.6<br>9.9<br>10.9<br>11.4<br>7.8<br>12.1<br>8.0<br>8.6<br>8.9<br>9.4<br>9.9<br>10.3<br>10.9 |             |                                     |     |     |     |

EF



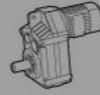

EF37

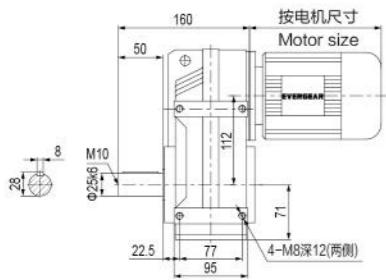

EFAB37

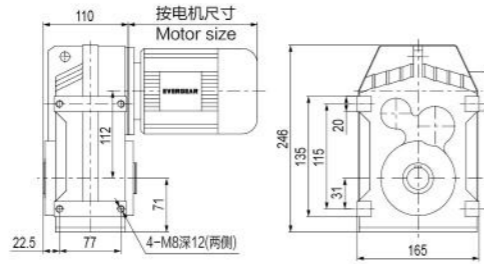

EF..S37

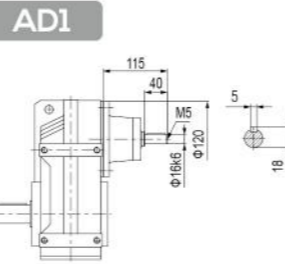

EFF37

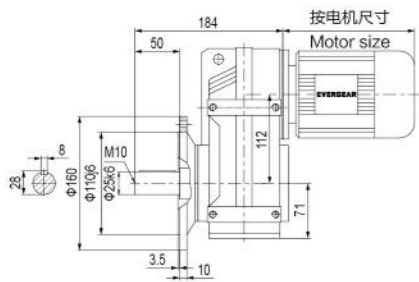

EFAF37

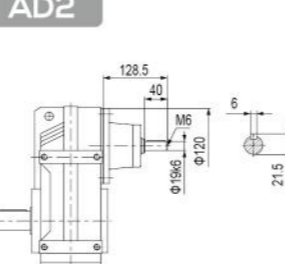
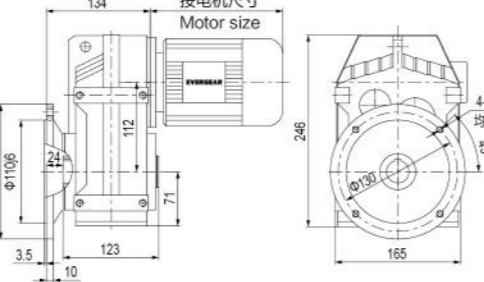

EFA37

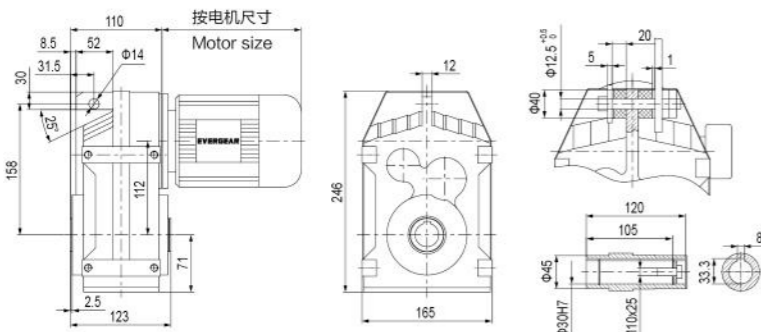

EF..37ER17

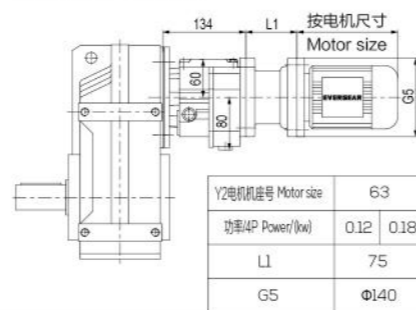

|                   |           |      |
|-------------------|-----------|------|
| Y2电机座号 Motor size | 63        | 71   |
| 功率4P Power/(kw)   | 0.12 0.18 | 0.25 |
| L1                | 75        | 75   |
| G5                | Φ140      | Φ160 |

EFAZ37

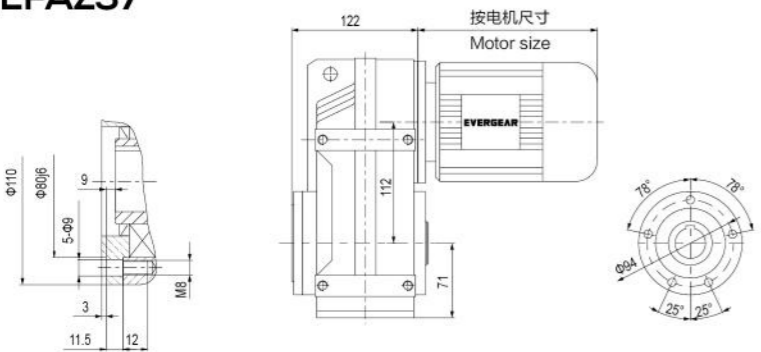

EF..37

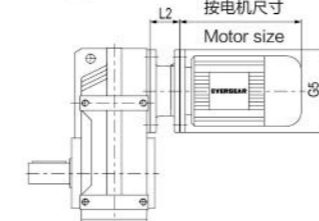

需方自配电机需加联接法兰  
Customers provide the motor by themselves need connected flange

|                   |           |           |           |         |       |
|-------------------|-----------|-----------|-----------|---------|-------|
| Y2电机座号 Motor size | 63        | 71        | 80        | 90      | 100   |
| 功率4P Power/(kw)   | 0.12 0.18 | 0.25 0.37 | 0.55 0.75 | 1.1 1.5 | 2.2 3 |
| L2                | 75        | 75        | 88.5      | 88.5    | 95.5  |
| G5                | Φ140      | Φ160      | Φ200      | Φ200    | Φ250  |

EF47

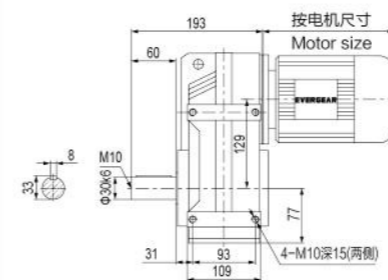

EFAB47

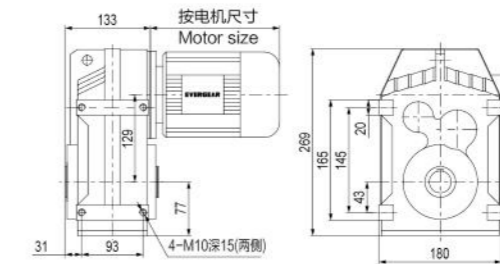

EF..S47

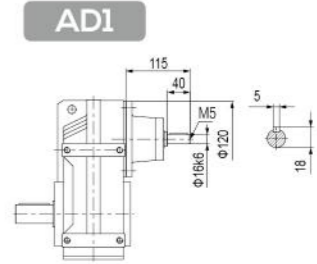

EFF47

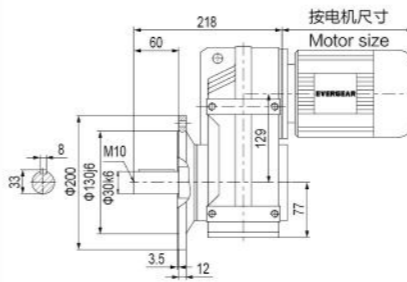

EFAF47

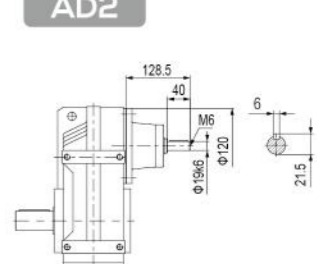
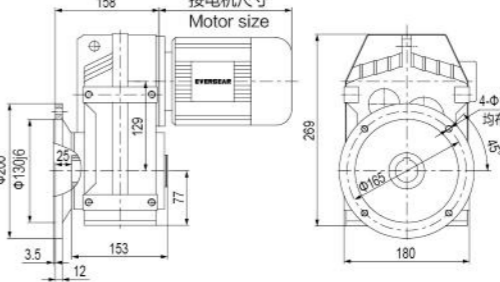

EFA47

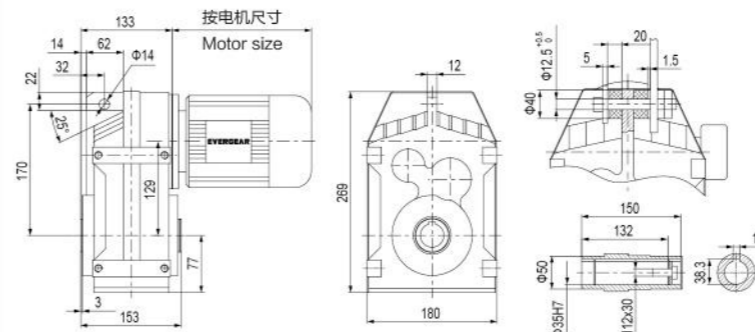

EF..47ER17

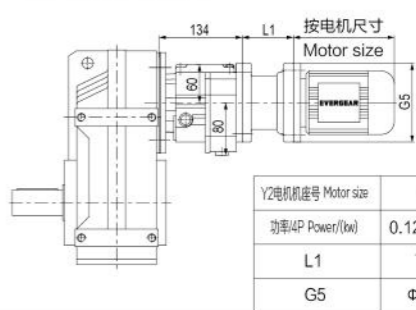

|                   |           |           |
|-------------------|-----------|-----------|
| Y2电机座号 Motor size | 63        | 71        |
| 功率4P Power/(kw)   | 0.12 0.18 | 0.25 0.37 |
| L1                | 75        | 75        |
| G5                | Φ140      | Φ160      |

EFAZ47

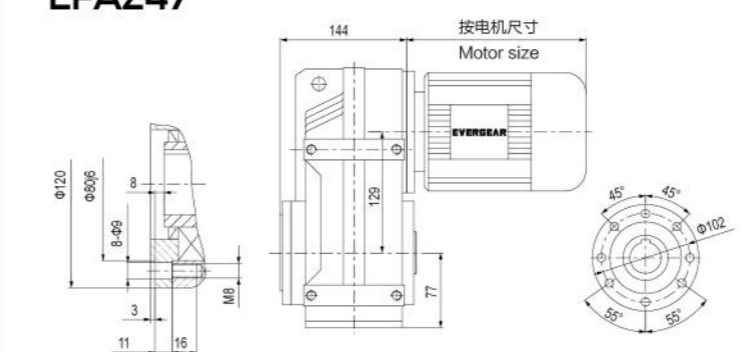

EF..47

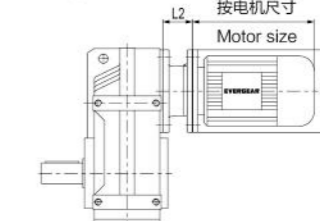

需方自配电机需加联接法兰  
Customers provide the motor by themselves need connected flange

|                   |           |           |           |         |       |
|-------------------|-----------|-----------|-----------|---------|-------|
| Y2电机座号 Motor size | 63        | 71        | 80        | 90      | 100   |
| 功率4P Power/(kw)   | 0.12 0.18 | 0.25 0.37 | 0.55 0.75 | 1.1 1.5 | 2.2 3 |
| L2                | 75        | 75        | 88.5      | 88.5    | 95.5  |
| G5                | Φ140      | Φ160      | Φ200      | Φ200    | Φ250  |

1.以上壳体为通用件,安装尺寸可以互相参照。  
2."EF.."表示EF系列所有结构形式。  
3.EFA、EFAF、EFAZ、EFAB输出轴为通用件,尺寸相同。  
4.带胀紧盘结构形式,胀紧盘尺寸详见007页。

1.The above housings are common parts, The mounting dimensions may consult each other.  
2."EF.." mean all mounting type of EF series.  
3.The output shafts of EFA、EFAF、EFAZ、EFAB are common parts, dimensions are the same.  
4.With expansion plate mounting type, see P007 for size details of expansion plate.

1.以上壳体为通用件,安装尺寸可以互相参照。  
2."EF.."表示EF系列所有结构形式。  
3.EFA、EFAF、EFAZ、EFAB输出轴为通用件,尺寸相同。  
4.带胀紧盘结构形式,胀紧盘尺寸详见007页。

1.The above housings are common parts, The mounting dimensions may consult each other.  
2."EF.." mean all mounting type of EF series.  
3.The output shafts of EFA、EFAF、EFAZ、EFAB are common parts, dimensions are the same.  
4.With expansion plate mounting type, see P007 for size details of expansion plate.

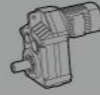

EF57

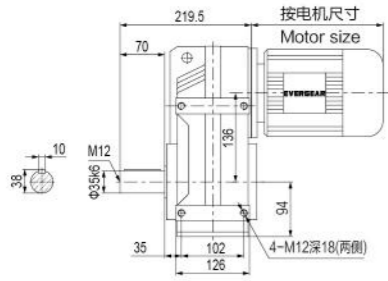

EFAB57

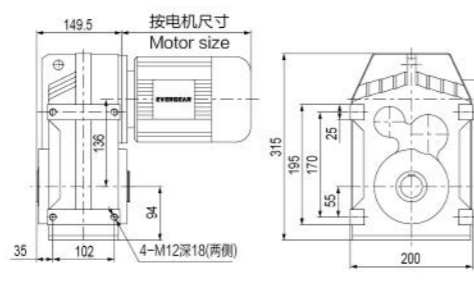

EF..S57

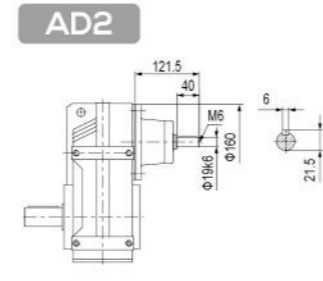

EFF57

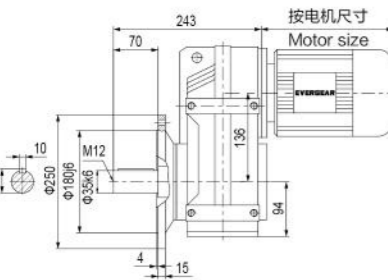

EFAF57

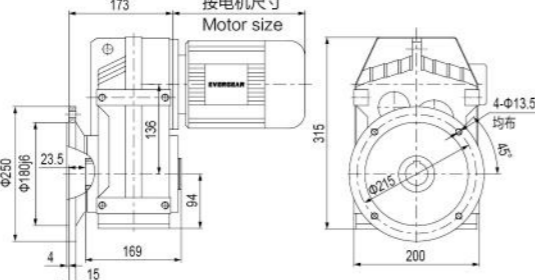

AD3

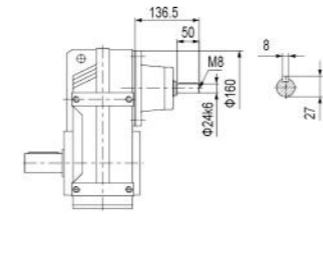

EFA57

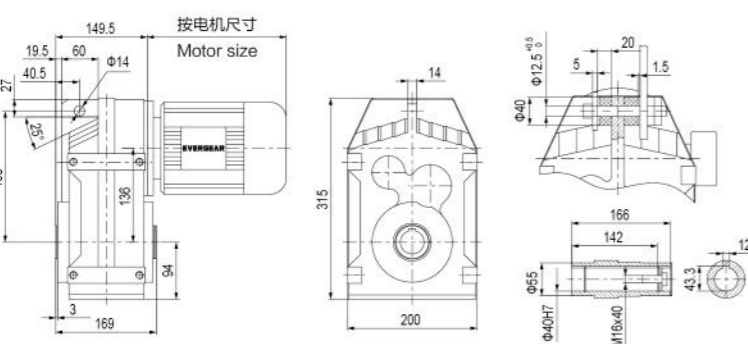

EF..57ER37

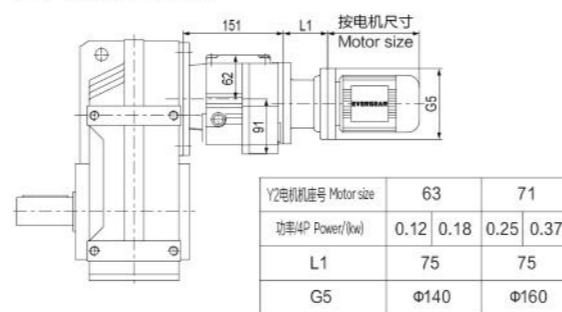

EFAZ57

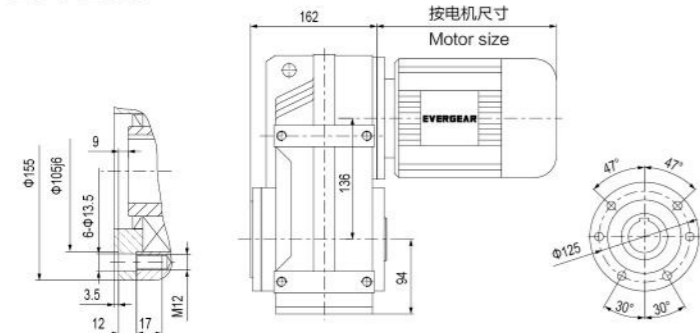

EF..57

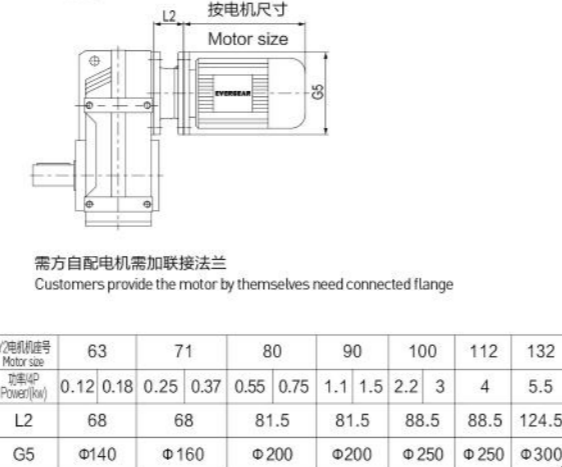

EF67

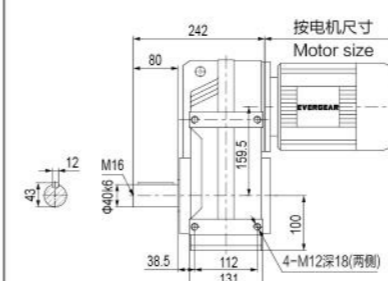

EFAB67

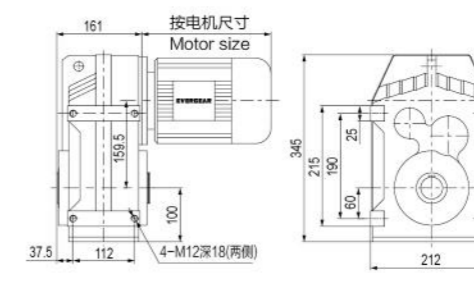

EF..S67

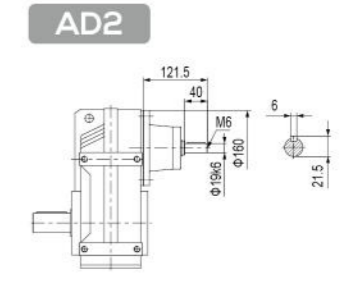

EFF67

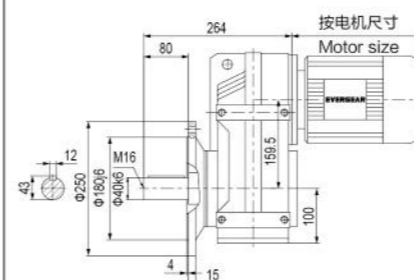

EFAF67

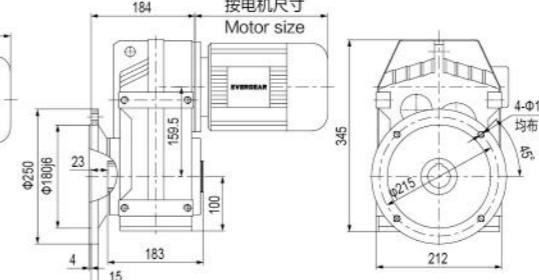

AD3

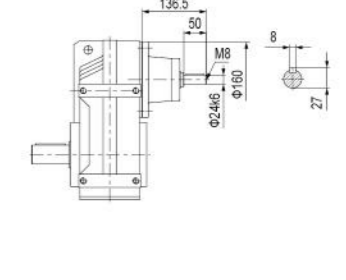

EFA67

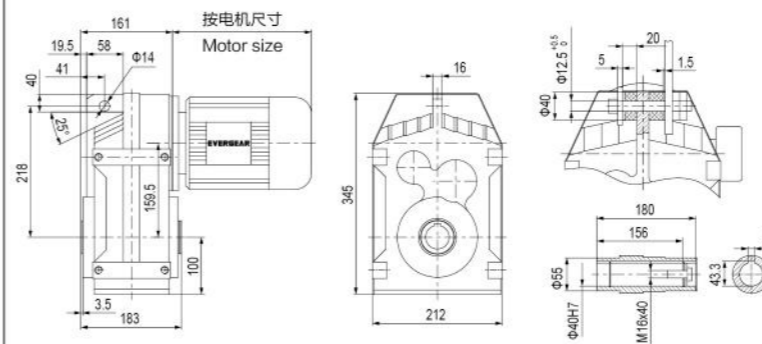

EF..67ER37

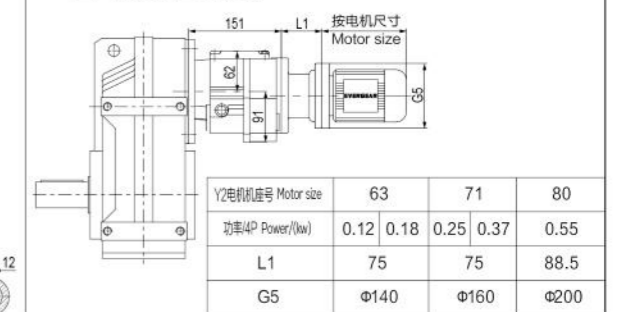

EFAZ67

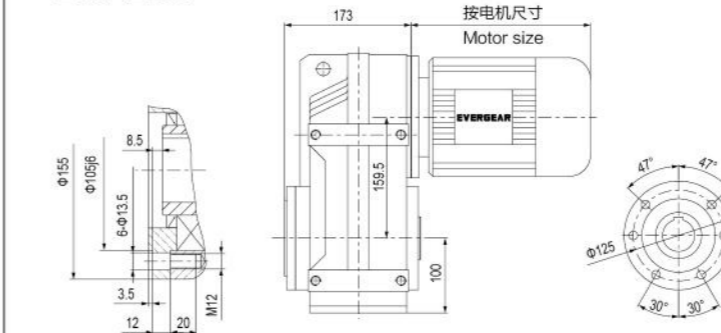

EF..67

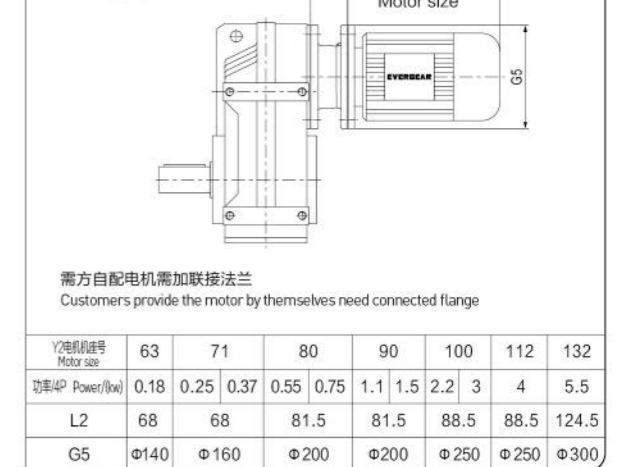

1.以上壳体为通用件,安装尺寸可以互相参照。  
2."EF.."表示EF系列所有结构形式。  
3.EFA、EFAF、EFAZ、EFAB输出轴为通用件,尺寸相同。  
4.带胀紧盘结构形式,胀紧盘尺寸详见007页。

1.The above housings are common parts, The mounting dimensions may consult each other.  
2."EF.." mean all mounting type of EF series.  
3.The output shafts of EFA、EFAF、EFAZ、EFAB are common parts, dimensions are the same.  
4.With expansion plate mounting type, see P007 for size details of expansion plate.

1.以上壳体为通用件,安装尺寸可以互相参照。  
2."EF.."表示EF系列所有结构形式。  
3.EFA、EFAF、EFAZ、EFAB输出轴为通用件,尺寸相同。  
4.带胀紧盘结构形式,胀紧盘尺寸详见007页。

1.The above housings are common parts, The mounting dimensions may consult each other.  
2."EF.." mean all mounting type of EF series.  
3.The output shafts of EFA、EFAF、EFAZ、EFAB are common parts, dimensions are the same.  
4.With expansion plate mounting type, see P007 for size details of expansion plate.



### EF77

### EFAB77

### EF..S77

#### AD2

#### AD3

#### AD4

### EFF77

### EFAF77

### EFA77

### EFAZ77

### EF..77ER37

|                   |           |           |           |
|-------------------|-----------|-----------|-----------|
| Y2电机座号 Motor size | 63        | 71        | 80        |
| 功率/kW Power/(kw)  | 0.12 0.18 | 0.25 0.37 | 0.55 0.75 |
| L1                | 75        | 75        | 88.5      |
| G5                | Φ140      | Φ160      | Φ200      |

### EF..77

需方自配电机需加联接法兰  
Customers provide the motor by themselves need connected flange

|                   |      |      |      |      |      |      |      |   |     |     |    |
|-------------------|------|------|------|------|------|------|------|---|-----|-----|----|
| Y2电机座号 Motor size | 71   | 80   | 90   | 100  | 112  | 132  | 160  |   |     |     |    |
| 功率/kW Power/(kw)  | 0.37 | 0.55 | 0.75 | 1.1  | 1.5  | 2.2  | 3    | 4 | 5.5 | 7.5 | 11 |
| L2                | 60.5 | 74   | 74   | 81   | 81   | 117  | 156  |   |     |     |    |
| G5                | Φ160 | Φ200 | Φ200 | Φ250 | Φ250 | Φ300 | Φ350 |   |     |     |    |

**注意** 1.以上壳体为通用件,安装尺寸可以互相参照。  
2."EF.."表示EF系列所有结构形式。  
3.EFA, EFAF, EFAZ, EFAB输出轴为通用件,尺寸相同。  
4.带胀紧盘结构形式,胀紧盘尺寸详见008页。

1.The above housings are common parts, The mounting dimensions may consult each other.  
2."EF.." mean all mounting type of EF series.  
3.The output shafts of EFA, EFAF, EFAZ, EFAB are common parts, dimensions are the same.  
4.With expansion plate mounting type, see P008 for size details of expansion plate.

### EF87

### EFAB87

### EF..S87

#### AD2

#### AD3

#### AD4

#### AD5

### EFF87

### EFAF87

### EFA87

### EFAZ87

### EF..87ER57

|                   |           |           |           |         |
|-------------------|-----------|-----------|-----------|---------|
| Y2电机座号 Motor size | 63        | 71        | 80        | 90      |
| 功率/kW Power/(kw)  | 0.12 0.18 | 0.25 0.37 | 0.55 0.75 | 1.1 1.5 |
| L1                | 68        | 68        | 81.5      | 81.5    |
| G5                | Φ140      | Φ160      | Φ200      | Φ200    |

### EF..87

需方自配电机需加联接法兰  
Customers provide the motor by themselves need connected flange

|                   |      |      |      |      |      |      |      |     |    |    |      |    |
|-------------------|------|------|------|------|------|------|------|-----|----|----|------|----|
| Y2电机座号 Motor size | 80   | 90   | 100  | 112  | 132  | 160  | 180  |     |    |    |      |    |
| 功率/kW Power/(kw)  | 0.75 | 1.1  | 1.5  | 2.2  | 3    | 4    | 5.5  | 7.5 | 11 | 15 | 18.5 | 22 |
| L2                | 72   | 72   | 79   | 79   | 113  | 152  | 152  |     |    |    |      |    |
| G5                | Φ200 | Φ200 | Φ250 | Φ250 | Φ300 | Φ350 | Φ350 |     |    |    |      |    |

**注意** 1.以上壳体为通用件,安装尺寸可以互相参照。  
2."EF.."表示EF系列所有结构形式。  
3.EFA, EFAF, EFAZ, EFAB输出轴为通用件,尺寸相同。  
4.带胀紧盘结构形式,胀紧盘尺寸详见008页。

1.The above housings are common parts, The mounting dimensions may consult each other.  
2."EF.." mean all mounting type of EF series.  
3.The output shafts of EFA, EFAF, EFAZ, EFAB are common parts, dimensions are the same.  
4.With expansion plate mounting type, see P008 for size details of expansion plate.

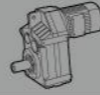

EF97

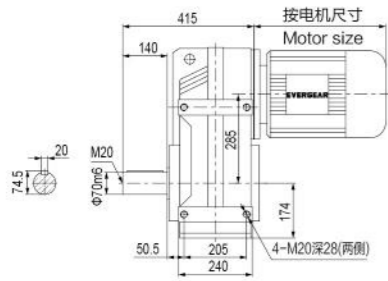

EFAB97

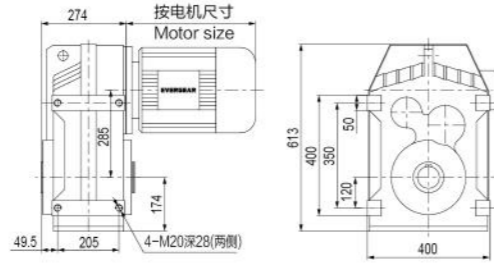

EF..S97

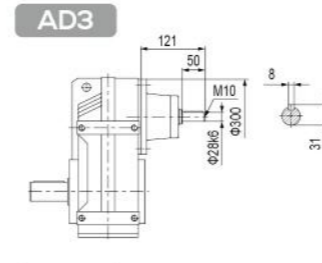

EFF97

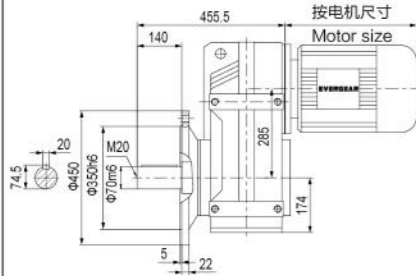

EFAF97

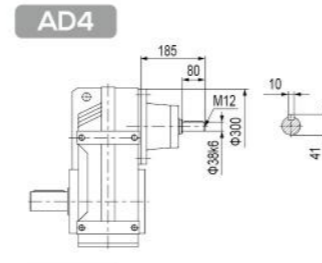
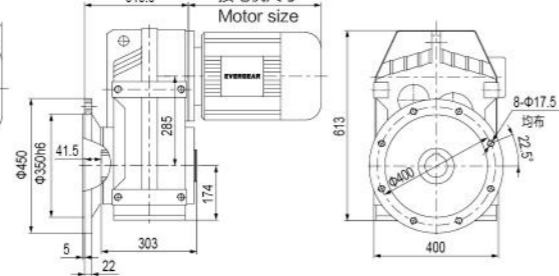

EFA97

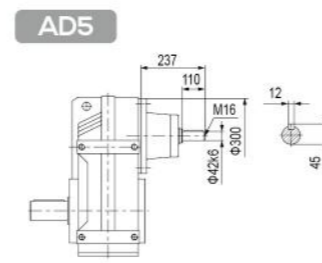
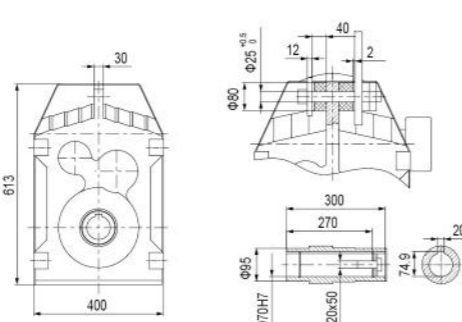
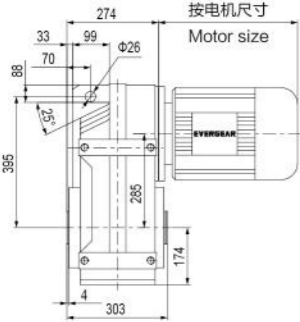

EFAZ97

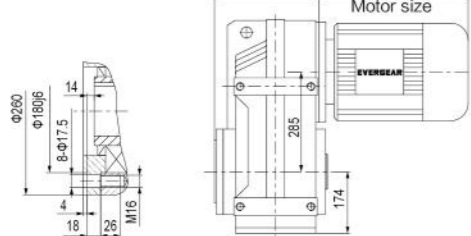

EF..97ER57

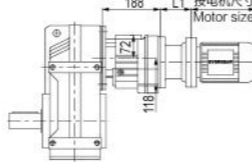

| Y2电机型号 Motor size | 63   | 71   | 80   | 90   | 100  |      |     |     |     |
|-------------------|------|------|------|------|------|------|-----|-----|-----|
| 功率4P Power(kw)    | 0.12 | 0.18 | 0.25 | 0.37 | 0.55 | 0.75 | 1.1 | 1.5 | 2.2 |
| L1                | 68   | 68   | 81.5 | 81.5 | 88.5 |      |     |     |     |
| G5                | φ140 | φ160 | φ200 | φ200 | φ250 |      |     |     |     |

EF..97

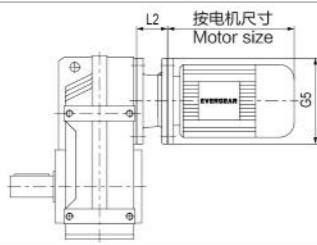

需方自配电机需加联接法兰  
Customers provide the motor by themselves need connected flange

| Y2电机型号 Motor size | 90   | 100  | 112  | 132  | 160  | 180  | 200  |    |    |      |    |    |
|-------------------|------|------|------|------|------|------|------|----|----|------|----|----|
| 功率4P Power(kw)    | 1.1  | 1.5  | 2.2  | 3    | 4    | 5.5  | 7.5  | 11 | 15 | 18.5 | 22 | 30 |
| L2                | 66   | 73   | 73   | 99   | 138  | 138  | 146  |    |    |      |    |    |
| G5                | φ200 | φ250 | φ250 | φ300 | φ350 | φ350 | φ400 |    |    |      |    |    |

EF107

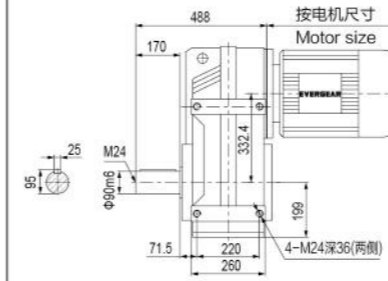

EFAB107

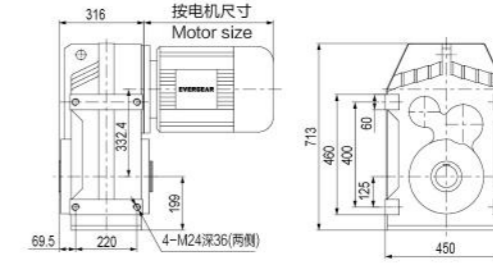

EF..S107

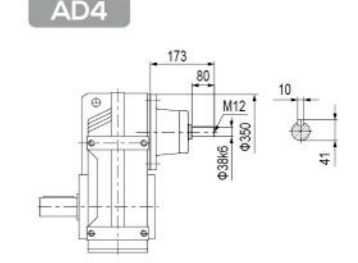

EFF107

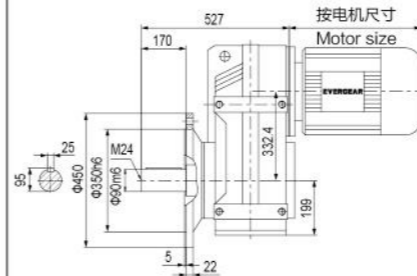

EFAF107

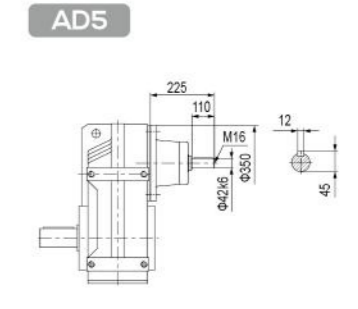
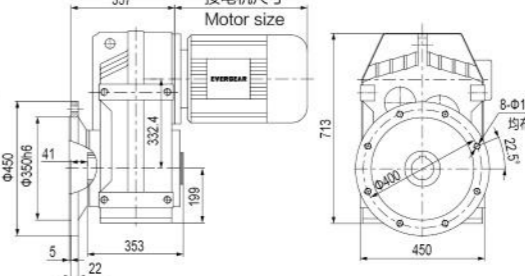

EFA107

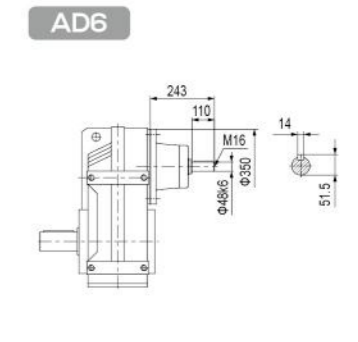
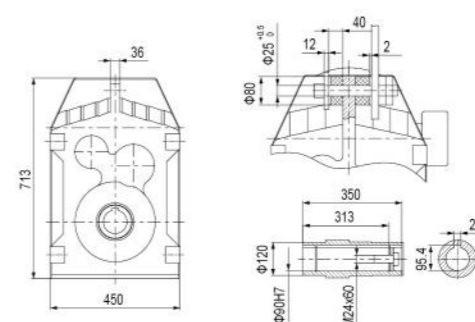
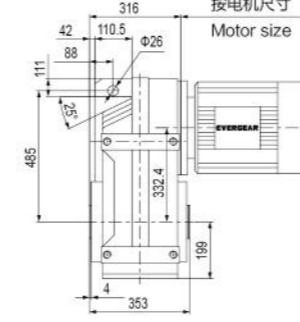

EFAZ107

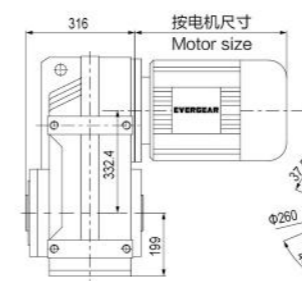
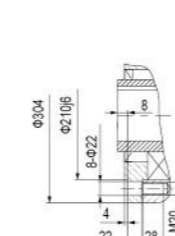

EF..107ER77

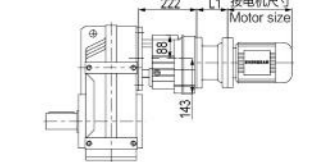

| Y2电机型号 Motor size | 63   | 71   | 80   | 90   | 100  | 112  |     |     |     |   |   |
|-------------------|------|------|------|------|------|------|-----|-----|-----|---|---|
| 功率4P Power(kw)    | 0.12 | 0.18 | 0.25 | 0.37 | 0.55 | 0.75 | 1.1 | 1.5 | 2.2 | 3 | 4 |
| L1                | 60.5 | 60.5 | 74   | 74   | 81   | 81   |     |     |     |   |   |
| G5                | φ140 | φ160 | φ200 | φ200 | φ250 | φ250 |     |     |     |   |   |

EF..107

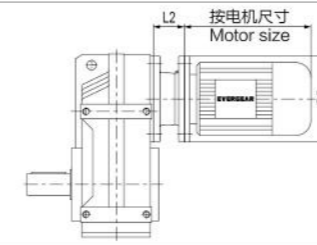

需方自配电机需加联接法兰  
Customers provide the motor by themselves need connected flange

| Y2电机型号 Motor size | 100  | 112  | 132  | 160  | 180  | 200  | 225  |      |    |    |    |    |
|-------------------|------|------|------|------|------|------|------|------|----|----|----|----|
| 功率4P Power(kw)    | 2.2  | 3    | 4    | 5.5  | 7.5  | 11   | 15   | 18.5 | 22 | 30 | 37 | 45 |
| L2                | 65   | 65   | 87   | 126  | 126  | 134  | 177  |      |    |    |    |    |
| G5                | φ250 | φ250 | φ300 | φ350 | φ350 | φ400 | φ450 |      |    |    |    |    |

1.以上壳体为通用件,安装尺寸可以互相参照。  
2."EF.."表示EF系列所有结构形式。  
3.EFA、EFAF、EFAZ、EFAB输出轴为通用件,尺寸相同。  
4.带膨胀盘结构形式,膨胀盘尺寸详见P008页。

1.The above housings are common parts, The mounting dimensions may consult each other.  
2."EF.." mean all mounting type of EF series.  
3.The output shafts of EFA、EFAF、EFAZ、EFAB are common parts, dimensions are the same.  
4.With expansion plate mounting type, see P008 for size details of expansion plate.

1.以上壳体为通用件,安装尺寸可以互相参照。  
2."EF.."表示EF系列所有结构形式。  
3.EFA、EFAF、EFAZ、EFAB输出轴为通用件,尺寸相同。  
4.带膨胀盘结构形式,膨胀盘尺寸详见P008页。

1.The above housings are common parts, The mounting dimensions may consult each other.  
2."EF.." mean all mounting type of EF series.  
3.The output shafts of EFA、EFAF、EFAZ、EFAB are common parts, dimensions are the same.  
4.With expansion plate mounting type, see P008 for size details of expansion plate.



EF127

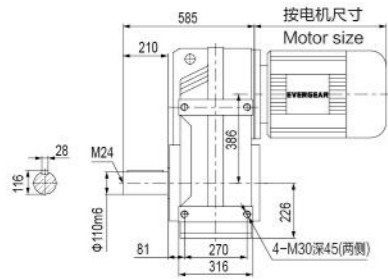

EFAB127

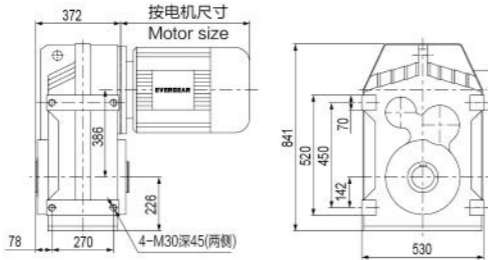

EFF127

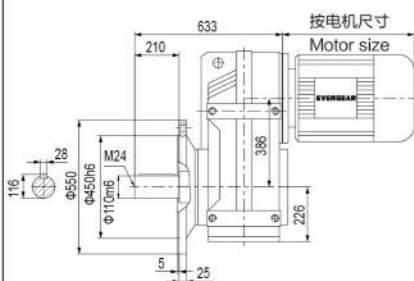

EFAF127

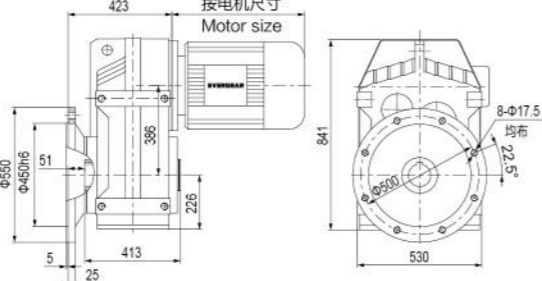

EFA127

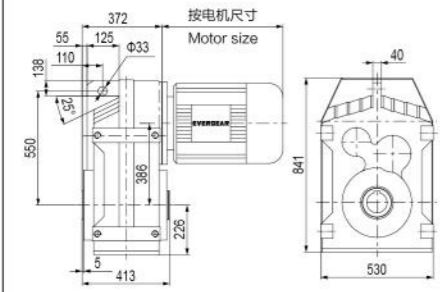

EF..127ER87

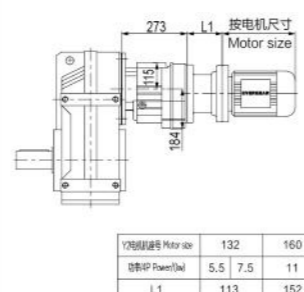

|                   |      |      |
|-------------------|------|------|
| Y2电机型号 Motor size | 132  | 160  |
| 功率4P Power(kw)    | 5.5  | 7.5  |
| L1                | 113  | 152  |
| G5                | φ300 | φ350 |

EFAZ127

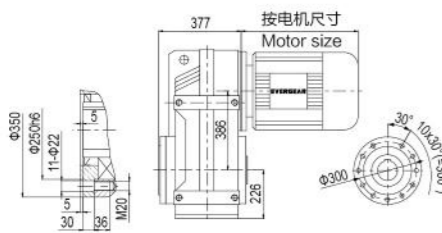

EF..127ER77

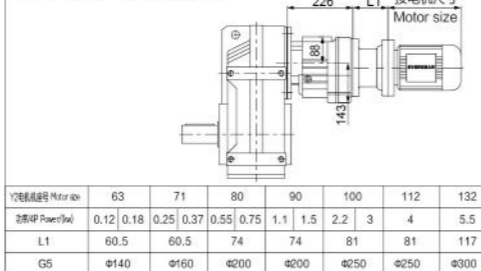

|                   |      |      |      |      |      |      |      |
|-------------------|------|------|------|------|------|------|------|
| Y2电机型号 Motor size | 63   | 71   | 80   | 90   | 100  | 112  | 132  |
| 功率4P Power(kw)    | 0.12 | 0.18 | 0.25 | 0.37 | 0.55 | 0.75 | 1.1  |
| L1                | 60.5 | 60.5 | 74   | 74   | 81   | 81   | 117  |
| G5                | φ140 | φ160 | φ200 | φ200 | φ250 | φ250 | φ300 |

EF..127

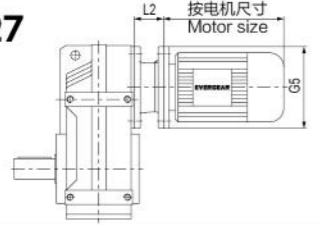

需方自配电机需加联接法兰  
Customers provide the motor by themselves need connected flange

|                   |      |      |      |      |      |      |      |
|-------------------|------|------|------|------|------|------|------|
| Y2电机型号 Motor size | 132  | 160  | 180  | 200  | 225  | 250  | 280  |
| 功率4P Power(kw)    | 7.5  | 11   | 15   | 18.5 | 22   | 30   | 37   |
| L2                | 77   | 116  | 116  | 124  | 167  | 192  | 192  |
| G5                | φ300 | φ350 | φ350 | φ400 | φ450 | φ550 | φ550 |

EF..S127

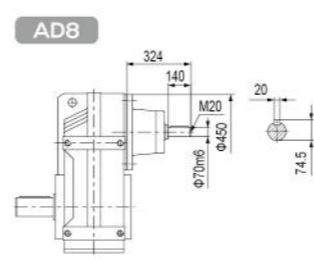
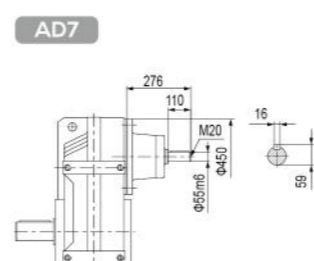
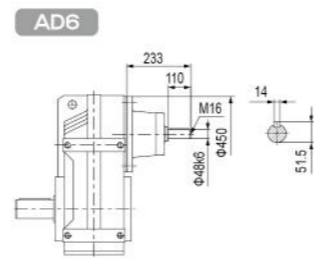
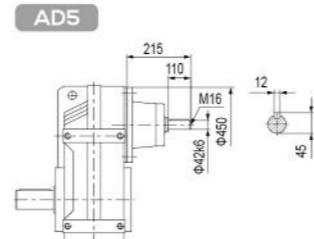
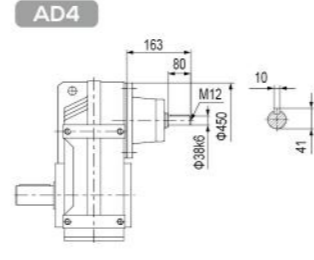

EF157

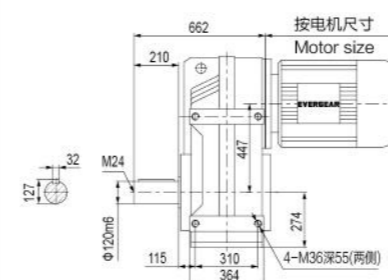

EFAB157

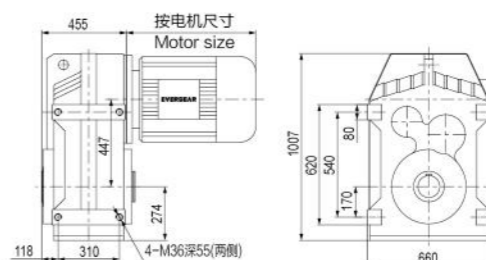

EFF157

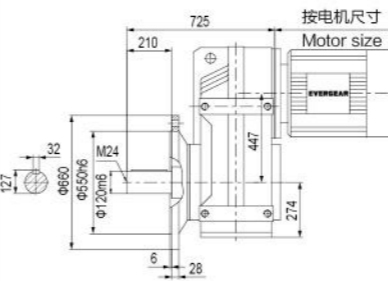

EFAF157

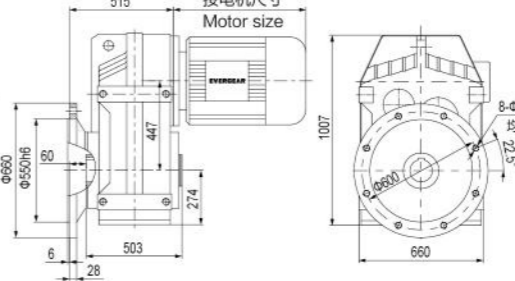

EFA157

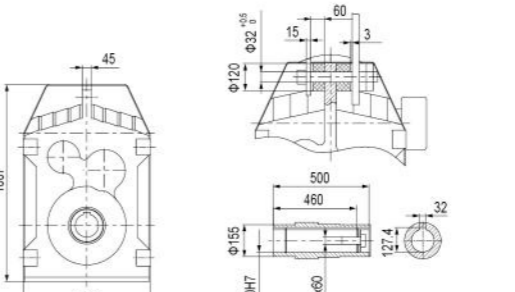
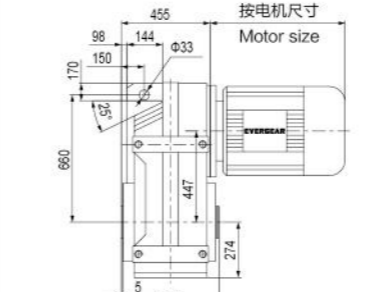

EFAZ157

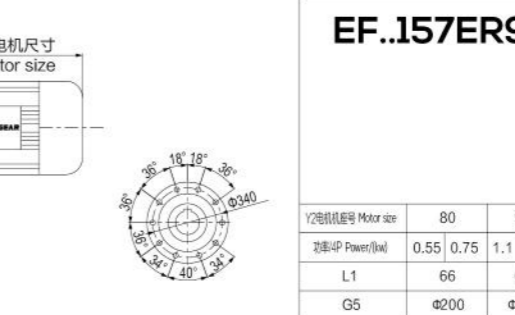
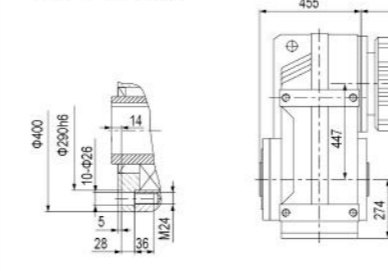

EF..157

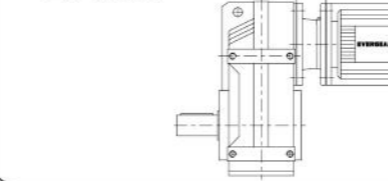

需方自配电机需加联接法兰  
Customers provide the motor by themselves need connected flange

|                   |      |      |      |      |      |      |      |
|-------------------|------|------|------|------|------|------|------|
| Y2电机型号 Motor size | 160  | 180  | 200  | 225  | 250  | 280  | 315  |
| 功率4P Power(kw)    | 11   | 15   | 18.5 | 22   | 30   | 37   | 45   |
| L2                | 112  | 112  | 120  | 163  | 183  | 183  | 196  |
| G5                | φ350 | φ350 | φ400 | φ450 | φ550 | φ550 | φ660 |

EF..S157

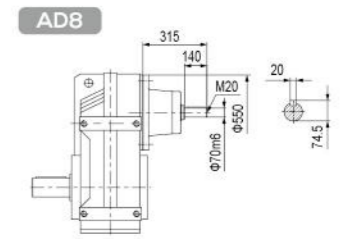
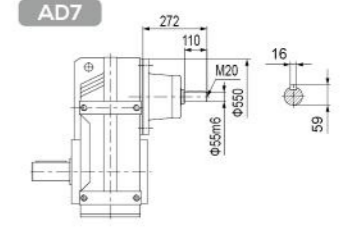
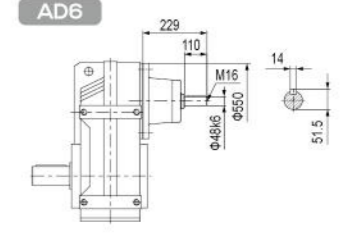
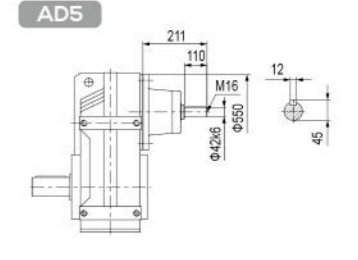

EF..157ER97

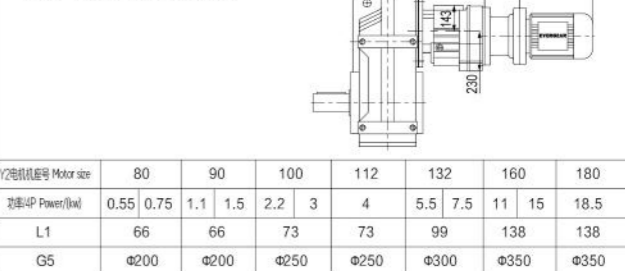

|                   |      |      |      |      |      |      |      |
|-------------------|------|------|------|------|------|------|------|
| Y2电机型号 Motor size | 80   | 90   | 100  | 112  | 132  | 160  | 180  |
| 功率4P Power(kw)    | 0.55 | 0.75 | 1.1  | 1.5  | 2.2  | 3    | 4    |
| L1                | 66   | 66   | 73   | 73   | 99   | 138  | 138  |
| G5                | φ200 | φ200 | φ250 | φ250 | φ300 | φ350 | φ350 |

1.以上壳体为通用件,安装尺寸可以互相参照。  
2."EF.."表示EF系列所有结构形式。  
3.EFA、EFAF、EFAZ、EFAB输出轴为通用件,尺寸相同。  
4.带膨胀盘结构形式,膨胀盘尺寸详见008页。

1.The above housings are common parts, The mounting dimensions may consult each other.  
2."EF.." mean all mounting type of EF series.  
3.The output shafts of EFA、EFAF、EFAZ、EFAB are common parts, dimensions are the same.  
4.With expansion plate mounting type,see P008 for size details of expansion plate.

1.以上壳体为通用件,安装尺寸可以互相参照。  
2."EF.."表示EF系列所有结构形式。  
3.EFA、EFAF、EFAZ、EFAB输出轴为通用件,尺寸相同。  
4.带膨胀盘结构形式,膨胀盘尺寸详见008页。

1.The above housings are common parts, The mounting dimensions may consult each other.  
2."EF.." mean all mounting type of EF series.  
3.The output shafts of EFA、EFAF、EFAZ、EFAB are common parts, dimensions are the same.  
4.With expansion plate mounting type,see P008 for size details of expansion plate.